

DC PASS

GPS Series

RF Surge Protection For GPS

PolyPhaser's GPS series integrates fast acting, non-degrading SASD technology into our new DC Pass family of RF surge protectors. Unlike gas tube arrestors that will degrade with each lightning strike, the PolyPhaser SASD technology ensures reliable, dependable and tested performance.



FEATURES

- Frequency Range 1.2 GHz to 1.6 GHz
- Multiple Connector Options
- Fast SASD (Silicon Avalanche Suppression Diode) Protection
- Ultra low voltage and energy let through
- Repeatable performance that doesn't degrade with time
- IP67 Weatherized Bulkhead Mount
- Protects against ESD discharges that occur on fleet based GPS Systems

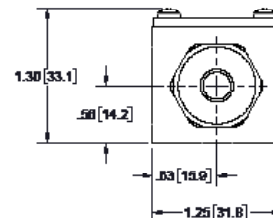
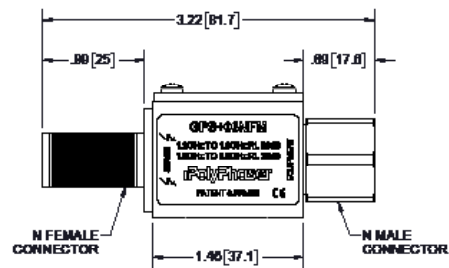

SPECIFICATIONS

	GPS+06NFSF	GPS+06NFF	GPS+06NFM
Voltage	6 Vdc	6 Vdc	6 Vdc
Maximum Surge (single)	20 kA	20 kA	20 kA
Maximum Surge (multiple)	10 kA	10 kA	10 kA
Frequency Range	1.2 GHz to 1.6 GHz	1.2 GHz to 1.6 GHz	1.2 GHz to 1.6 GHz
Technology	SASD	SASD	SASD
Let-Through Energy	<175µJ	<175µJ	<175µJ
Insertion Loss	≤0.1 dB	≤0.1 dB	≤0.1 dB
Bidirectional	No	No	No
Weatherized	Yes	Yes	Yes
Mount	Bulkhead	Bulkhead	Bulkhead
Connector	SMA-Female N-Type Female	N-Type Female N-Type Female	N-Type Female N-Type Female