

## CB 系列高速离心鼓风机性能参数表

Performance table of series CB high-speed centrifugal blower

风机型号 Type of Blower	进气状态 Suction Condition				升压 Discharge Pressure kPa	轴功率 Axial Power kW	电机 Motor		机组重量 Blower Weight kg	进口法兰 Inlet Flange DN (PN1.0MPa)	出口法兰 Outlet Flange DN (PN1.0MPa)
	流量 Capacity m <sup>3</sup> /min	压力 Pressure kPa	温度 Temperature °C	密度 Density kg/m <sup>3</sup>			功率 Power kW	重量 Weight kg			
CB80-1.5	80	101.32	20	1.2	49	71.7	90	625	4915	DN300	DN250
CB80-1.6	80	101.32	20	1.2	58.8	84.1	110	900	5190		
CB80-1.7	80	101.32	20	1.2	68.6	96.8	132	1080	5430		
CB80-1.8	80	101.32	20	1.2	78.4	108.3	132	1080	5430		
CB80-1.9	80	101.32	20	1.2	88.2	119.4	160	1130	5480		
CB80-2.0	80	101.32	20	1.2	98.0	130.2	185	1130	5480		
CB80-2.1	80	101.32	20	1.2	107.8	139.5	185	1130	5480		
CB80-2.2	80	101.32	20	1.2	117.6	149.5	185	1130	5480		
CB80-2.3	80	101.32	20	1.2	127.4	159.2	200	1270	5620		
CB80-2.4	80	101.32	20	1.2	137.2	168.6	220	1600	6000		
CB80-2.5	80	101.32	20	1.2	147	177.8	220	1600	6000		
CB80-2.6	80	101.32	20	1.2	156.8	186.8	250	1630	6030		
CB80-2.7	80	101.32	20	1.2	166.6	195.5	250	1630	6030		
CB80-2.8	80	101.32	20	1.2	176.4	204.0	250	1630	6030		
CB100-1.5	100	101.32	20	1.2	49	89.7	110	900	5350		
CB100-1.6	100	101.32	20	1.2	58.8	105.2	132	1100	5450		
CB100-1.7	100	101.32	20	1.2	68.6	120.9	160	1130	5480		
CB100-1.8	100	101.32	20	1.2	78.4	135.4	160	1130	5480		
CB100-1.9	100	101.32	20	1.2	88.2	149.3	200	1270	5510		
CB100-2.0	100	101.32	20	1.2	98.0	162.7	200	1270	5540		
CB100-2.1	100	101.32	20	1.2	107.8	174.4	220	1600	5870		
CB100-2.2	100	101.32	20	1.2	117.6	186.9	250	1630	5900		
CB100-2.3	100	101.32	20	1.2	127.4	199.0	250	1630	5900		
CB100-2.4	100	101.32	20	1.2	137.2	210.8	280	1780	6180		
CB100-2.5	100	101.32	20	1.2	147	222.3	280	1780	6180		
CB100-2.6	100	101.32	20	1.2	156.8	233.5	315	1780	6380		
CB100-2.7	100	101.32	20	1.2	166.6	244.4	315	1780	6380		
CB100-2.8	100	101.32	20	1.2	176.4	255.0	315	1780	6380		
CB125-1.5	125	101.32	20	1.2	49	112.5	160	1130	5700		
CB125-1.6	125	101.32	20	1.2	58.8	131.5	160	1130	5700		
CB125-1.7	125	101.32	20	1.2	68.6	151.2	185	1130	5700		
CB125-1.8	125	101.32	20	1.2	78.4	169.2	200	1270	5840		
CB125-1.9	125	101.32	20	1.2	88.2	186.6	220	1600	6170		
CB125-2.0	125	101.32	20	1.2	98.0	203.4	250	1630	6200		
CB125-2.1	125	101.32	20	1.2	107.8	218.0	280	1780	6350		
CB125-2.2	125	101.32	20	1.2	117.6	233.6	315	1780	6350		
CB125-2.3	125	101.32	20	1.2	127.4	248.8	315	1780	6350		
CB125-2.4	125	101.32	20	1.2	137.2	263.8	355	2700	7270		
CB125-2.5	125	101.32	20	1.2	147	277.5	355	2700	7270		
CB125-2.6	125	101.32	20	1.2	156.8	291.9	355	2700	7270		
CB125-2.7	125	101.32	20	1.2	166.6	305.5	400	2780	7350		
CB125-2.8	125	101.32	20	1.2	176.4	318.8	400	2780	7350		

风机型号 Type of Blower	进气状态 Suction Condition				升压 Discharge Pressure kPa	轴功率 Axial Power kW	电机 Motor		机组重量 Blower Weight kg	进口法兰 Inlet Flange DN (PN1.0MPa)	出口法兰 Outlet Flange DN (PN1.0MPa)
	流量 Capacity m <sup>3</sup> /min	压力 Pressure kPa	温度 Temperature °C	密度 Density kg/m <sup>3</sup>			功率 Power kW	重量 Weight kg			
CB150-1.5	150	101.32	20	1.2	49	135.0	160	1130	5420	DN400	DN350
CB150-1.6	150	101.32	20	1.2	58.8	157.8	200	1270	5560		
CB150-1.7	150	101.32	20	1.2	68.6	181.4	220	1600	5890		
CB150-1.8	150	101.32	20	1.2	78.4	203.1	250	1630	6030		
CB150-1.9	150	101.32	20	1.2	88.2	223.9	280	1780	6100		
CB150-2.0	150	101.32	20	1.2	98.0	244.1	315	1780	6170		
CB150-2.1	150	101.32	20	1.2	107.8	261.6	315	1780	6170		
CB150-2.2	150	101.32	20	1.2	117.6	280.4	355	2700	7090		
CB150-2.3	150	101.32	20	1.2	127.4	298.5	400	2780	7290		
CB150-2.4	150	101.32	20	1.2	137.2	316.5	400	2780	7290		
CB150-2.5	150	101.32	20	1.2	147	333.4	400	2780	7290		
CB150-2.6	150	101.32	20	1.2	156.8	353.0	450	2900	7410		
CB150-2.7	150	101.32	20	1.2	166.6	366.6	450	2900	7410		
CB150-2.8	150	101.32	20	1.2	176.4	382.5	450	2900	7410		
CB200-1.5	200	101.32	20	1.2	49	179.4	220	1600	5970		
CB200-1.6	200	101.32	20	1.2	58.8	210.4	250	1630	6000		
CB200-1.7	200	101.32	20	1.2	68.6	241.9	315	1780	6150		
CB200-1.8	200	101.32	20	1.2	78.4	270.7	355	2700	6150		
CB200-1.9	200	101.32	20	1.2	88.2	298.6	355	2700	6350		
CB200-2.0	200	101.32	20	1.2	98.0	325.4	400	2780	6350		
CB200-2.1	200	101.32	20	1.2	107.8	348.8	450	2900	6470		
CB200-2.2	200	101.32	20	1.2	117.6	373.8	450	2900	6470		
CB200-2.3	200	101.32	20	1.2	127.4	398.0	500	3000	6570		
CB200-2.4	200	101.32	20	1.2	137.2	422.0	500	3000	6570		
CB200-2.5	200	101.32	20	1.2	147	444.0	560	4000	8180		
CB200-2.6	200	101.32	20	1.2	156.8	467.0	560	4000	8380		
CB200-2.7	200	101.32	20	1.2	166.6	488.8	630	4300	8680		
CB200-2.8	200	101.32	20	1.2	176.4	510.0	630	4300	8680		
CB250-1.5	250	101.32	20	1.2	49	224.3	280	1780	7200		
CB250-1.6	250	101.32	20	1.2	58.8	263.0	355	2700	8120		
CB250-1.7	250	101.32	20	1.2	68.6	302.4	355	2700	8500		
CB250-1.8	250	101.32	20	1.2	78.4	338.4	400	2780	8580		
CB250-1.9	250	101.32	20	1.2	88.2	373.2	450	2900	8700		
CB250-2.0	250	101.32	20	1.2	98.0	406.8	500	3000	8800		
CB250-2.1	250	101.32	20	1.2	107.8	436.0	560	4000	10100		
CB250-2.2	250	101.32	20	1.2	117.6	467.1	560	4000	10100		
CB250-2.3	250	101.32	20	1.2	127.4	497.5	630	4300	10400		
CB250-2.4	250	101.32	20	1.2	137.2	527.5	630	4300	10400		
CB250-2.5	250	101.32	20	1.2	147	555.0	710	4600	10700		
CB250-2.6	250	101.32	20	1.2	156.8	583.8	710	4600	10700		
CB250-2.7	250	101.32	20	1.2	166.6	611.0	710	4600	10700		
CB250-2.8	250	101.32	20	1.2	176.4	637.5	800	4900	11000		

风机型号 Type of Blower	进气状态 Suction Condition				升压 Discharge Pressure kPa	轴功率 Axial Power kW	电机 Motor		机组重量 Blower Weight kg	进口法兰 Inlet Flange DN (PN1.0MPa)	出口法兰 Outlet Flange DN (PN1.0MPa)
	流量 Capacity m <sup>3</sup> /min	压力 Pressure kPa	温度 Temperature °C	密度 Density kg/m <sup>3</sup>			功率 Power kW	重量 Weight kg			
CB300-1.5	300	101.32	20	1.2	49	269.1	355	2700	8530	DN600	DN500
CB300-1.6	300	101.32	20	1.2	58.8	315.6	400	2780	8530		
CB300-1.7	300	101.32	20	1.2	68.6	364.9	450	2900	8650		
CB300-1.8	300	101.32	20	1.2	78.4	408.5	500	3000	8750		
CB300-1.9	300	101.32	20	1.2	88.2	450.5	560	4000	9850		
CB300-2.0	300	101.32	20	1.2	98.0	491.1	630	4300	10180		
CB300-2.1	300	101.32	20	1.2	107.8	523.2	630	4300	10180		
CB300-2.2	300	101.32	20	1.2	117.6	560.7	710	4600	10780		
CB300-2.3	300	101.32	20	1.2	127.4	597.0	710	4600	10780		
CB300-2.4	300	101.32	20	1.2	137.2	633.0	800	4900	11080		
CB300-2.5	300	101.32	20	1.2	147	666.0	800	4900	11080		
CB300-2.6	300	101.32	20	1.2	156.8	700.5	800	4900	11080		
CB300-2.7	300	101.32	20	1.2	166.6	733.2	900	5200	11380		
CB300-2.8	300	101.32	20	1.2	176.4	765.0	900	5200	11380		
CB350-1.5	350	101.32	20	1.2	49	313.9	400	2780	8660		
CB350-1.6	350	101.32	20	1.2	58.8	368.2	450	2900	8680		
CB350-1.7	350	101.32	20	1.2	68.6	425.8	500	3000	8780		
CB350-1.8	350	101.32	20	1.2	78.4	476.6	560	4000	9880		
CB350-1.9	350	101.32	20	1.2	88.2	525.6	630	4300	9980		
CB350-2.0	350	101.32	20	1.2	98.0	569.5	710	4600	10580		
CB350-2.1	350	101.32	20	1.2	107.8	610.4	710	4600	10580		
CB350-2.2	350	101.32	20	1.2	117.6	654.2	800	4900	10880		
CB350-2.3	350	101.32	20	1.2	127.4	696.5	800	4900	10880		
CB350-2.4	350	101.32	20	1.2	137.2	738.5	900	5200	11180		
CB350-2.5	350	101.32	20	1.2	147	802.6	1000	5440	11420		
CB350-2.6	350	101.32	20	1.2	156.8	817.3	1000	5440	11420		
CB350-2.7	350	101.32	20	1.2	166.6	855.4	1000	5440	11700		
CB350-2.8	350	101.32	20	1.2	176.4	892.5	1000	5440	11700		
CB400-1.5	400	101.32	20	1.2	49	358.8	450	2900	8400		
CB400-1.6	400	101.32	20	1.2	58.8	420.8	500	3000	8500		
CB400-1.7	400	101.32	20	1.2	68.6	491.5	630	4300	9800		
CB400-1.8	400	101.32	20	1.2	78.4	550.0	630	4300	9980		
CB400-1.9	400	101.32	20	1.2	88.2	606.3	710	4600	10580		
CB400-2.0	400	101.32	20	1.2	98.0	650.9	800	4900	10880		
CB400-2.1	400	101.32	20	1.2	107.8	697.6	800	4900	10880		
CB400-2.2	400	101.32	20	1.2	117.6	747.6	900	5200	11180		
CB400-2.3	400	101.32	20	1.2	127.4	796.0	1000	5440	11420		
CB400-2.4	400	101.32	20	1.2	137.2	844.0	1120	5650	11630		
CB400-2.5	400	101.32	20	1.2	147	917.9	1120	5650	11900		
CB400-2.6	400	101.32	20	1.2	156.8	934.0	1120	5650	11900		
CB400-2.7	400	101.32	20	1.2	166.6	977.6	1250	5880	12130		
CB400-2.8	400	101.32	20	1.2	176.4	1020.0	1250	5880	12130		

风机型号 Type of Blower	进气状态 Suction Condition				升压 Discharge Pressure kPa	轴功率 Axial Power kW	电机 Motor		机组重量 Blower Weight kg	进口法兰 Inlet Flange DN (PN1.0MPa)	出口法兰 Outlet Flange DN (PN1.0MPa)
	流量 Capacity m <sup>3</sup> /min	压力 Pressure kPa	温度 Temperature °C	密度 Density kg/m <sup>3</sup>			功率 Power kW	重量 Weight kg			
CB500-1.5	500	101.32	20	1.2	49	448.5	560	4000	9900	DN700	DN600
CB500-1.6	500	101.32	20	1.2	58.8	526.0	630	4300	10200		
CB500-1.7	500	101.32	20	1.2	68.6	614.3	710	4600	10500		
CB500-1.8	500	101.32	20	1.2	78.4	687.7	800	4900	10650		
CB500-1.9	500	101.32	20	1.2	88.2	757.8	900	5200	10700		
CB500-2.0	500	101.32	20	1.2	98.0	818.4	1000	5440	11850		
CB500-2.1	500	101.32	20	1.2	107.8	872.0	1120	5650	12360		
CB500-2.2	500	101.32	20	1.2	117.6	934.5	1120	5650	12360		
CB500-2.3	500	101.32	20	1.2	127.4	995.0	1250	5880	12590		
CB500-2.4	500	101.32	20	1.2	137.2	1055.0	1250	5880	12590		
CB500-2.5	500	101.32	20	1.2	147	1146.8	1400	6800	13550		
CB500-2.6	500	101.32	20	1.2	156.8	1167.5	1400	6800	13850		
CB500-2.7	500	101.32	20	1.2	166.6	1222.0	1400	6800	13850		
CB500-2.8	500	101.32	20	1.2	176.4	1275.0	1400	6800	13850		
CB600-1.5	600	101.32	20	1.2	49	538.2	630	4300	12350		
CB600-1.6	600	101.32	20	1.2	58.8	631.2	800	4900	12550		
CB600-1.7	600	101.32	20	1.2	68.6	737.4	900	5200	12850		
CB600-1.8	600	101.32	20	1.2	78.4	825.1	1000	5440	13090		
CB600-1.9	600	101.32	20	1.2	88.2	909.7	1120	5650	13210		
CB600-2.0	600	101.32	20	1.2	98.0	982.1	1250	5880	13680		
CB600-2.1	600	101.32	20	1.2	107.8	1046.4	1250	5880	13980		
CB600-2.2	600	101.32	20	1.2	117.6	1121.4	1400	6800	14900		
CB600-2.3	600	101.32	20	1.2	127.4	1194.0	1400	6800	14900		
CB600-2.4	600	101.32	20	1.2	137.2	1266.0	1600	6900	15000		
CB600-2.5	600	101.32	20	1.2	147	1332.0	1600	6900	15000		
CB600-2.6	600	101.32	20	1.2	156.8	1401.0	1600	6900	15000		
CB600-2.7	600	101.32	20	1.2	166.6	1466.4	1800	7160	15260		
CB600-2.8	600	101.32	20	1.2	176.4	1530.0	1800	7160	15260		
CB700-1.5	700	101.32	20	1.2	49	627.9	800	4900	12700	DN800	DN700
CB700-1.6	700	101.32	20	1.2	58.8	736.4	900	5200	13000		
CB700-1.7	700	101.32	20	1.2	68.6	840.2	1000	5440	13240		
CB700-1.8	700	101.32	20	1.2	78.4	940.3	1120	5650	13350		
CB700-1.9	700	101.32	20	1.2	88.2	1036.9	1250	5880	13580		
CB700-2.0	700	101.32	20	1.2	98.0	1145.8	1400	6800	14500		
CB700-2.1	700	101.32	20	1.2	107.8	1220.8	1400	6800	14500		
CB700-2.2	700	101.32	20	1.2	117.6	1308.3	1600	6900	14600		
CB700-2.3	700	101.32	20	1.2	127.4	1393.0	1600	6900	14600		
CB700-2.4	700	101.32	20	1.2	137.2	1477.0	1800	7160	14860		
CB700-2.5	700	101.32	20	1.2	147	1554.0	1800	7160	14860		
CB700-2.6	700	101.32	20	1.2	156.8	1634.5	2000	9450	17300		
CB700-2.7	700	101.32	20	1.2	166.6	1710.8	2000	9450	17300		
CB700-2.8	700	101.32	20	1.2	176.4	1785.0	2000	9450	17300		

磁悬浮鼓风机

高速离心鼓风机

通风机

透平离心鼓风机

罗茨鼓风机

MVR

粉体工程输送系统

风机型号 Type of Blower	进气状态 Suction Condition				升压 Discharge Pressure kPa	轴功率 Axial Power kW	电机 Motor		机组重量 Blower Weight kg	进口法兰 Inlet Flange DN (PN1.0MPa)	出口法兰 Outlet Flange DN (PN1.0MPa)
	流量 Capacity m <sup>3</sup> /min	压力 Pressure kPa	温度 Temperature °C	密度 Density kg/m <sup>3</sup>			功率 Power kW	重量 Weight kg			
CB800-1.5	800	101.32	20	1.2	49	717.6	900	5200	13200	DN900	DN800
CB800-1.6	800	101.32	20	1.2	58.8	841.6	1000	5440	13440		
CB800-1.7	800	101.32	20	1.2	68.6	960.2	1120	5650	13650		
CB800-1.8	800	101.32	20	1.2	78.4	1074.6	1250	5880	13880		
CB800-1.9	800	101.32	20	1.2	88.2	1185.1	1400	6800	14800		
CB800-2.0	800	101.32	20	1.2	98.0	1312.0	1600	6900	14900		
CB800-2.1	800	101.32	20	1.2	107.8	1395.2	1600	6900	15200		
CB800-2.2	800	101.32	20	1.2	117.6	1495.2	1800	7160	15460		
CB800-2.3	800	101.32	20	1.2	127.4	1592.0	1800	7160	15460		
CB800-2.4	800	101.32	20	1.2	137.2	1688.0	2000	9450	17750		
CB800-2.5	800	101.32	20	1.2	147	1776.0	2000	9450	17750		
CB800-2.6	800	101.32	20	1.2	156.8	1868.0	2240	9850	18150		
CB800-2.7	800	101.32	20	1.2	166.6	1955.2	2240	9850	18150		
CB800-2.8	800	101.32	20	1.2	176.4	2040.0	2240	9850	18150		

注：以上机型仅供参考，可根据客户要求定制产品。

注：带“\*”号的电机为6kV高压电机，其余为380V。当鼓风机使用条件与上表不符时，需进行性能换算，我公司可根据用户要求进行非标设计，以满足用户各种工况的具体需要。

Notice: "\*" are 6kV high-voltage motor, others are motors with voltage 380V. When the atmospheric conditions and medium are varied, the relative performance conversion calculation will be different. We can re-designed in accordance with the requirement of users to adapt to different working condition.

### 风机性能曲线 (如: CB200-1.7)

Fan performance curve (e.g. cb200-1.7)

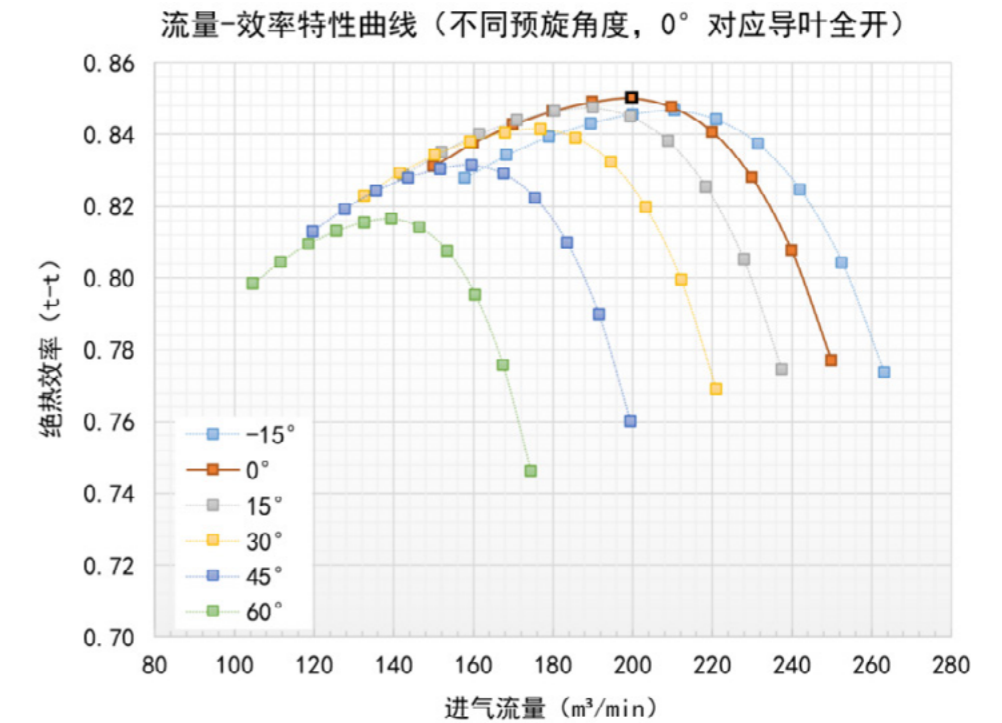
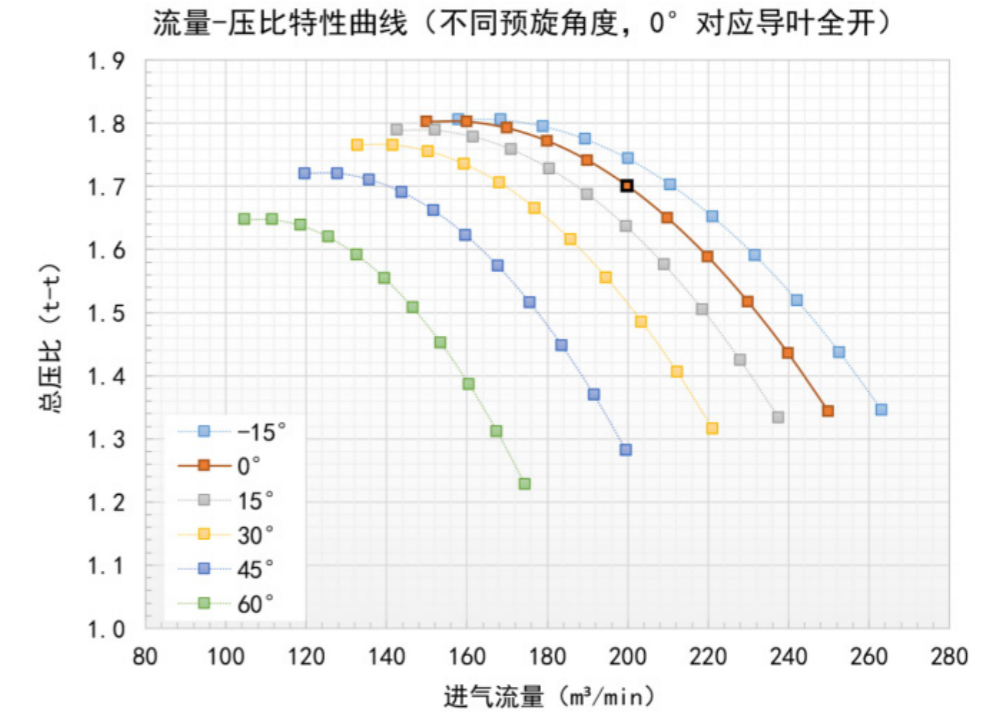

### 鼓风机外形安装尺寸图 (以合同提供图纸为准)

Outline and Installation Dimensions(Refer to the information given in the contract)

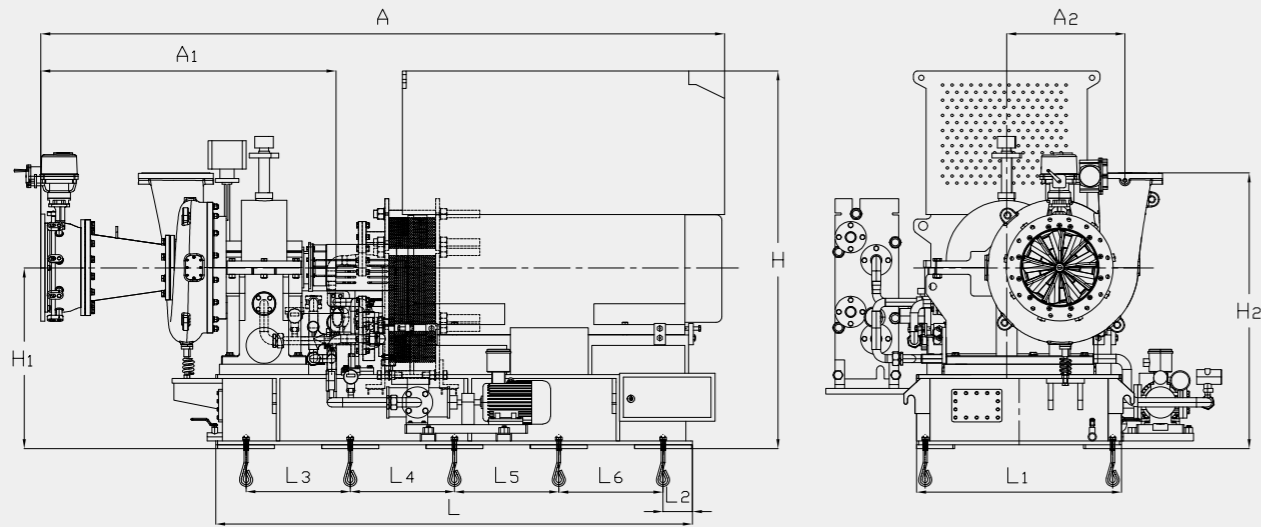

鼓风机型号	鼓风机外形尺寸							地基尺寸				
	A	A1	A2	H	H1	H2	L	L1	L2	L3-Ln	螺栓数量	螺栓规格
CB80-2.0	2300	1050	500	1400	865	1220	1800	1000	150	500	8	M20×500
CB100-2.0	2700	1150	550	1800	890	1300	2300	1100	150	500	10	
CB120-2.0	2900	1150	550	2000	890	1350	2400	1150	150	525	10	
CB130-2.0	3100	1200	580	2100	900	1400	2500	1180	150	550	10	
CB200-2.0	3800	1300	650	2400	960	1500	2800	1280	150	625	10	
CB260-2.0	4200	1400	700	2500	960	1550	2900	1300	150	520	12	
CB300-2.0	4500	1500	750	2600	1000	1600	3000	1320	150	540	12	
CB400-2.0	4800	1600	800	2800	1000	1650	3150	1350	150	570	12	
CB500-2.0	5200	1700	840	2900	1000	1700	3300	1380	150	600	12	
CB650-2.0	5500	1850	900	3000	1050	1730	3500	1420	150	640	12	
CB800-2.0	5700	2000	940	3200	1100	1760	3640	1460	200	540	14	

### 鼓风机典型配管图 (以合同提供图纸为准)

Typical Pipe Installation(Refer to the information given in the contract)

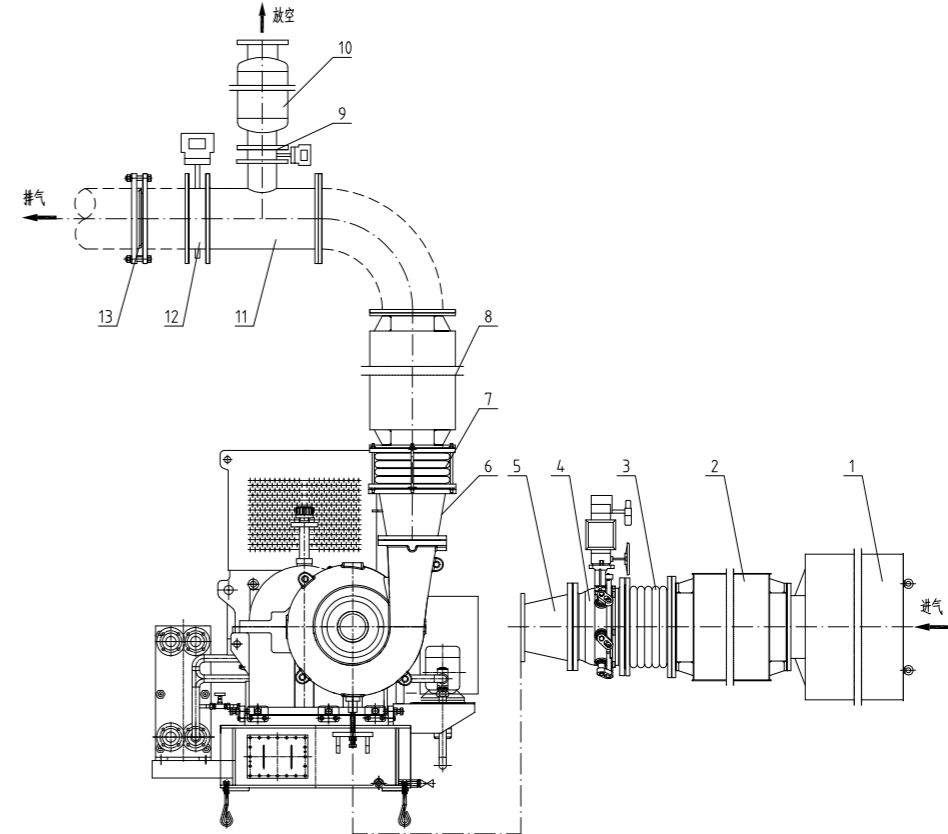

风机型号	配件及名称型号						
	1	2	3	4	5	6	7
	进口滤清器	进口消声器	进口波纹管	进口导叶器	进口变径管上游	进口变径管下游	出口变径管
CB80-2.0	ZRL-300	KMP-300	SHTJ-300	IGV-300	BJG-300-200	-	BJG-200-250
CB100-2.0	ZRL-350	KMP-350	SHTJ-350	IGV-350	BJG-500-300	-	BJG-450-250
CB200-2.0	ZRL-500	KMP-500	SHTJ-500	IGV-500	BJG-600-500	-	BJG-500-250
CB300-2.0	ZRL-600	KMP-600	SHTJ-600		BJG-600-500	BJG-500-300	BJG-500-250
CB400-2.0	ZRL-600	KMP-600	SHTJ-600		BJG-700-500	BJG-500-300	BJG-500-250
CB500-2.0	ZRL-700	KMP-700	SHTJ-700	IGV-700	BJG-800-500	BJG-500-300	BJG-600-300
CB650-2.0	ZRI-800	KMP-800	SHTJ-800		BJG-900-700	BJG-700-350	BJG-700-350
CB800-2.0	ZRL-900	KMP-900	SHTJ-900		BJG-1000-700	BJG-700-400	BJG-800-500
风机型号	配件及名称型号						
	7	8	9	10	11	12	13
	出口波纹管	出口消声器	放空蝶阀	放空消声器	出口三通	出口蝶阀	止回阀
CB80-2.0	SHTJ-250	KMP-250			ST-250-100	DN250	DN250
CB100-2.0	SHTJ-350	KMP-350	DN150	KMP-150	ST-450-150	DN450	DN450
CB200-2.0	SHTJ-450	KMP-450					
CB300-2.0	SHTJ-500	KMP-500	DN200	KMP-200	ST-500-200	DN500	DN500
CB400-2.0	SHTJ-500	KMP-500			ST-500-200	DN500	DN500
CB500-2.0	SHTJ-600	KMP-600	DN250	KMP-300	ST-600-200	DN600	DN600
CB650-2.0	SHTJ-700	KMP-700	DN250	KMP-300	ST-700-300	DN700	DN700
CB800-2.0	SHTJ-800	KMP-800	DN400	KMP-400	ST-800-400	DN800	DN800

## 配套产品

Accessories For Blowers

### DCV型单向阀

Type DCV Non-return Valve

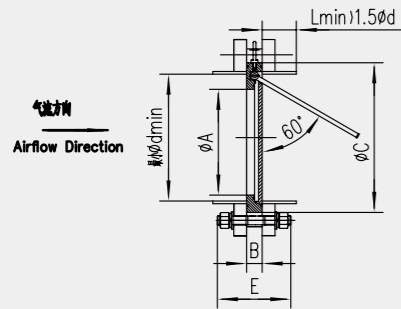

(GB1.0MPa 法兰Flange)

型号 Type	口径 Bore	d	A	B	C	E	重量 Weight
DCV-150	150A	150	115	18	215	120	3
DCV-200	200A	200	140	23	270	130	3.6
DCV-250	250A	250	185	38	326	150	6.75
DCV-300	300A	300	210	38	376	150	18.4
DCV-350	350A	345	255	80	440	200	24
DCV-400	400A	405	300	80	490	215	49.6
DCV-450	450A	450	345	80	540	215	64.2
DCV-500	500A	500	387	80	595	215	78.4
DCV-600	600A	600	455	80	690	230	88.7

### 三通

Three-way Pipe

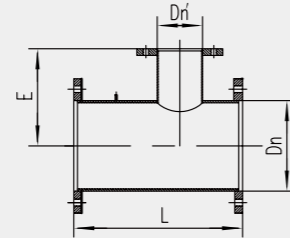

(GB1.0MPa 法兰Flange)

型号 Type	L	E	Dn	D' n
ST-125-150	320	220	150	125
ST-125-200	350	240	200	125
ST-125-250	420	270	250	125
ST-150-300	500	300	300	150
ST-150-350	600	320	345	150
ST-250-400	650	350	405	250
ST-250-450	700	400	450	250
ST-250-500	750	450	500	250
ST-250-600	800	480	600	250

### XSQ & ZRL型进口滤清器

Type XSQ & ZRL Inlet Filter

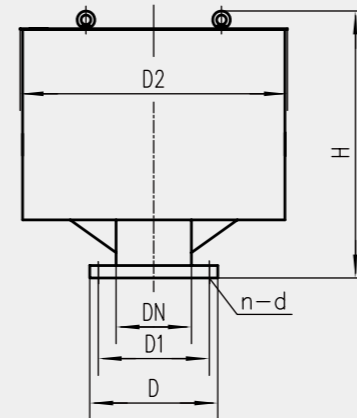

(GB1.0MPa 法兰Flange)

滤清器型号 Filter Type	滤清器主要尺寸 (mm) Filter Dimension						重量 Weight
	DN	D1	D	D2	n-d	H	
XSQ-ZG-150A	150	240	285	540	8-φ22	547	72
XSQ-ZG-200A	200	295	340	710	8-φ22	709	95
XSQ-ZG-250A	250	350	395	710	12-φ22	791	100
XSQ-ZG-300A	300	400	445	860	12-φ22	904	188
ZRL-200	200	295	340	530	8-φ22	490	27
ZRL-250	250	350	395	560	12-φ22	537	35
ZRL-300	300	400	445	690	12-φ22	643	49
ZRL-350	350	460	505	720	16-φ22	683	55
ZRL-400	400	515	565	910	16-φ26	813	100
ZRL-450	450	565	615	1010	20-φ26	913	120
ZRL-500	500	620	670	1110	20-φ26	1013	145
ZRL-600	600	725	780	1360	20-φ29	1105	185

### KMP消声器外形尺寸表

KMP silencer outline dimension table

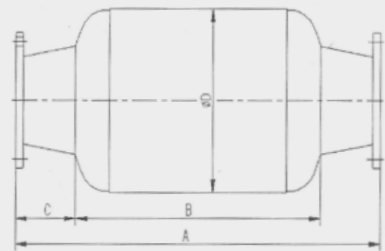

(GB1.0MPa 法兰Flange)

消声器型号 Silencer Type	口径 Bore	总长A	外筒直径D	外筒长度B (含封头)	封头与接管交点到法兰外面距离C	重量 (kg)
KMP-200	200A	1100	461	740	180	59
KMP-250	250A	1200	514	840	180	82
KMP-300	300A	1300	616	820	240	105
KMP-350	350A	1400	666	920	240	126
KMP-400	400A	1500	716	1020	240	147
KMP-450	450A	1600	766	1120	240	163
KMP-500	500A	2000	816	1520	240	219
KMP-600	600A	2300	918	1780	260	340
KMP-700	700A	2400	1018	1880	260	399

### 弹性接头 (KXT-III型)

Type KXT-III Flexible Connector

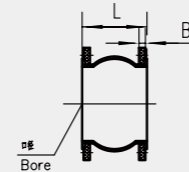

(GB1.0MPa 法兰Flange)

型号 Type	L	B	水平位移 (mm) Level Moving Distance		倾向位移 (mm) Bevel Displacement	偏转角度 (°) Deflection Angle	重量 Weight
			伸长 Elongation	压缩 Compressing			
150	180	24	12	20	14	15	11.9
200	190	24	16	25	22	15	13.5
250	230	28	16	25	22	15	20.8
300	245	28	16	25	22	15	24.6
350	255	28	16	25	22	15	30.5
400	255	30	16	25	22	15	32.5
450	255	30	16	25	22	15	37.3
500	255	32	16	25	22	15	55

### 进、出口法兰 (参照GB1.0MPa法兰)

Suction, Discharge Flange (According GB1.0MPa Flange)

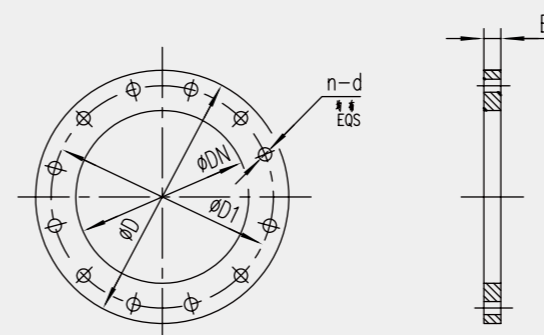

(GB1.0MPa 法兰Flange)

口径 Bore	DN	D	D1	B	n	d
125A	125	250	210	20	8	φ18
150A	150	285	240	22	8	φ22
200A	200	340	295	22	8	φ22
250A	250	395	350	22	12	φ22
300A	300	445	400	24	12	φ22
350A	350	505	460	24	16	φ22
400A	400	565	515	24	16	φ26
450A	450	615	565	24	20	φ26
500A	500	670	620	26	20	φ26
600A	600	780	725	26	20	φ29
700A	700	895	840	30	20	φ29
800A	800	1015	950	32	24	φ33
900A	900	1115	1050	34	24	φ33