

## SGR2-D Series Thermal Relay



### Technical data

Type	SGR2-D13,SGR2-D23,SGR2-D33,SGR2-D150,SGR2-D200, SGR2-D400,SGR2-D630,SGR2-F53,SGR2-F73
Standard	IEC60947-4-1
Approvals	CE, CB, TUV
Tripping class	10A
Rated insulation voltage $U_i$ (V)	690/1000
Rated impulse withstand voltage $U_{imp}$ (kV)	6/8
Signalling	Trip indicator
Tightening torque(N.m)	0.8
Degree of protection	IP20
Ambient air temperature(°C)	-5 to+40,max.95%humidity
Storage temperature(°C)	-40~+75
Maximum operating altitude (meters)	2000
Flame resistance	V1
Mounting	Directly under the contactor



## Selection and ordering data

### SGR2-D thermal relay matched with contactor SGC1-D

	Rated frame current (A)	Rated working current of thermal relay	Rated current (A)	Current setting range (A)	Matched fuse type aM (A)	gG (A)	Matched AC contactor
	25	SGR2-D 1301	0.16	0.10~0.16	0.25	2	SGC1-D09
		SGR2-D 1302	0.25	0.16~0.25	0.5	2	SGC1-D09
		SGR2-D 1303	0.40	0.25~0.40	1	2	SGC1-D09
		SGR2 D 1304	0.63	0.40~0.63	1	2	SGC1-D09
		SGR2-D 1305	1.0	0.63~1.0	2	4	SGC1-D09
		SGR2-D 1306	1.6	1.0~1.6	2	4	SGC1-D09
		SGR2-D 1306X	2.0	1.25~2.0	4	6	SGC1-D09
		SGR2-D 1307	2.5	1.6~2.5	4	6	SGC1-D09
		SGR2-D 1308	4.0	2.5~4.0	6	10	SGC1-D09
		SGR2-D 1310	6.0	4.0~6.0	8	16	SGC1-D09
		SGR2-D 1312	8.0	5.5~8.0	12	20	SGC1-D09
		SGR2-D 1314	10	7~10	12	20	SGC1-D12
		SGR2-D 1316	13	9~13	16	25	SGC1-D18
		SGR2-D 1321	18	12~18	20	35	SGC1-D18
SGR2-D 1322	25	17~25	25	50	SGC1-D25		
	36	SGR2-D 2353	32	23~32	40	63	SGC1-D32
		SGR2-D 2355	40	30~40	40	80	SGC1-D40
	93	SGR2-D 3353	32	23~32	40	63	SGC1-D32
		SGR2-D 3355	40	30~40	40	100	SGC1-D40
		SGR2-D 3357	50	37~50	63	100	SGC1-D50
		SGR2-D 3359	65	48~65	63	100	SGC1-D65
		SGR2-D 3361	70	55~70	80	125	SGC1-D80
		SGR2-D 3363	80	63~80	80	125	SGC1-D80
		SGR2-D 3365	93	80~93	100	160	SGC1-D95
		SGR2-D 150	150	80~150	160	250	SGC1-F115-150
		SGR2-D 200	200	80~200	200	315	SGC1-F115-150
		SGR2-D 400	400	160~400	400	630	SGC1-F225-400
SGR2-D 630	630	315~630	630	800	SGC1-F330-630		

### SGR2-F thermal relay matched with contactor SGC1-F

	Type code	Current setting range	Matched fuse type		Matched AC contactor
			aM Type (A)	gG Type (A)	
	SGR2-F53/50	30-50	50	80	SGC1-F115~F185
	SGR2-F53/80	48-80	80	125	SGC1-F115~F185
	SGR2-F53/100	60-100	100	200	SGC1-F115~F185
	SGR2-F53/150	90-150	160	250	SGC1-F115~F185
	SGR2-F53/220	132-220	250	315	SGC1-F225~F265
	SGR2-F73/330	200-330	400	500	SGC1-F225~F500
	SGR2-F73/500	300-500	500	800	SGC1-F225~F500
	SGR2-F73/630	380-630	630	800	SGC1-F400~F630

## 1. Overall and mounting dimensions( SGR2-D/SGR2-F Series )

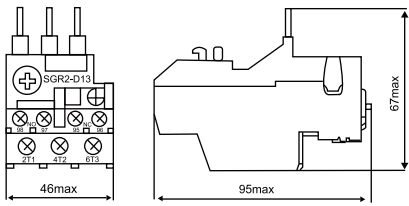

SGR2-D13

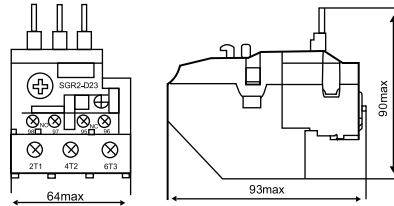

SGR2-D23

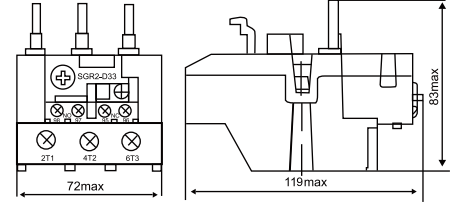

SGR2-D33

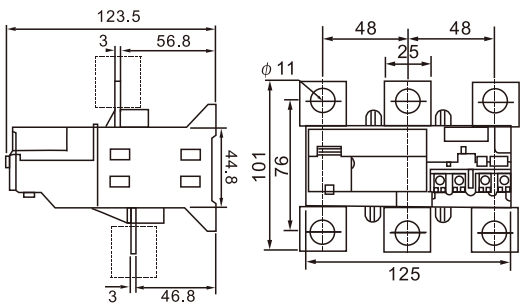

SGR2-F53/220

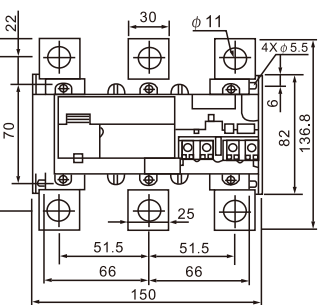
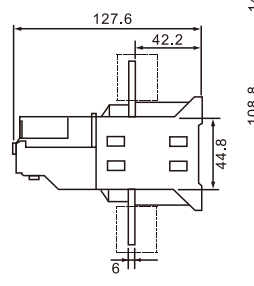
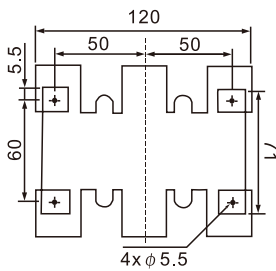

SGR2-F73/630

## 2. Tripping curve for thermal relay

### SGR2-D

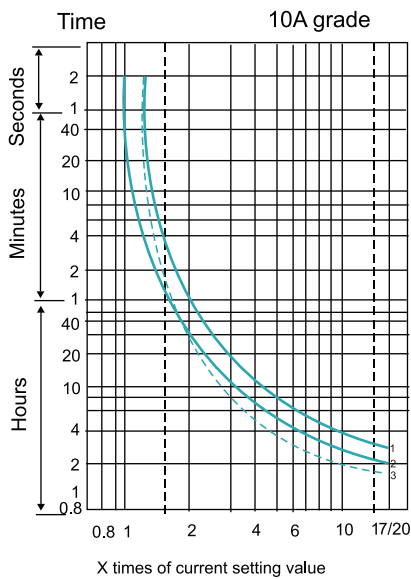

### SGR2-F

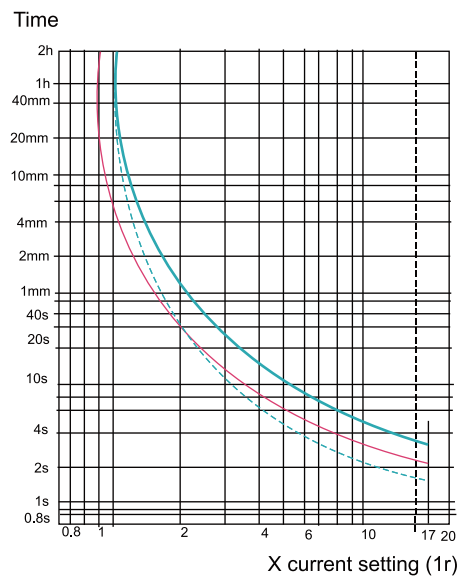

1. Equilibrium running, 3phase, start form cold state
2. Equilibrium running, 2phase, start form cold state
3. Equilibrium running, 3phase, after long period of setting current (hot state)

Derivative products of AC contactor, please refer to pictures below

