

# HB-DJ814

Data Sheet



Parameters	
HB-DJ814	
300x15	
450x15	
150	
25/10%	
100%	
100%	
100%	
100%	
1500x30	
1500x30	
Ø60 hole Ø13	
Ø60 hole Ø13	
Ground force wires	
Build in, undetectable	
6%	
6%	
IP65	
22.5	
12	

**LABEL STICKER**

HB-DJ814-300x15-450x15-150-25/10%

WUXI HONGBA

Wuxi Hongba Automation Co., Ltd.

Address: No. 2088, Xuhou Road, Wuxi, Jiangsu, China

Phone: +86-510-83622888

Website: www.hongba.com

Mail: hb@hongba.com

Year: 2002-2024

Made in China

www.hongba.com

## Overview

1. 24v or 48v brushed DC motor ;
2. Customizable stroke 50mm - 1000mm ;
3. Speed 5.5 mm/s ;
4. Max force 15,000 N ;
5. Operating temp. -15 °C to 40 °C ;
6. Weather protection IP65 ;
7. Endstop signal output and not cut off power automatically ;
8. CE certified ;
9. Suggest re-greasing every 3,000 cycles.



## Parameters

Code	Ratio (Worm Gear)	Free-Load Speed	Full-Load Speed	Max. Dynamic Force	Max. Self- Locking	24V DC		48V DC		Ball Screw Item No.
						Free-Load Current	Full-Load Current	Free-Load Current	Full-Load Current	
A	1 : 30	5.5 mm/s	5 mm/s	15,000 N	20,000 N	2.6 A	14 A	1.3 A	9.0 A	GQ2505
B	1 : 30	11 mm/s	10 mm/s	7,500 N	10,000 N	2.6 A	14 A	1.3 A	9.0 A	GQ2505

\* 24V: duty cycle 15%, 48v: duty cycle 20%, with full load and ambient temperature at 20 °C .

[Table 1]

## Dimension

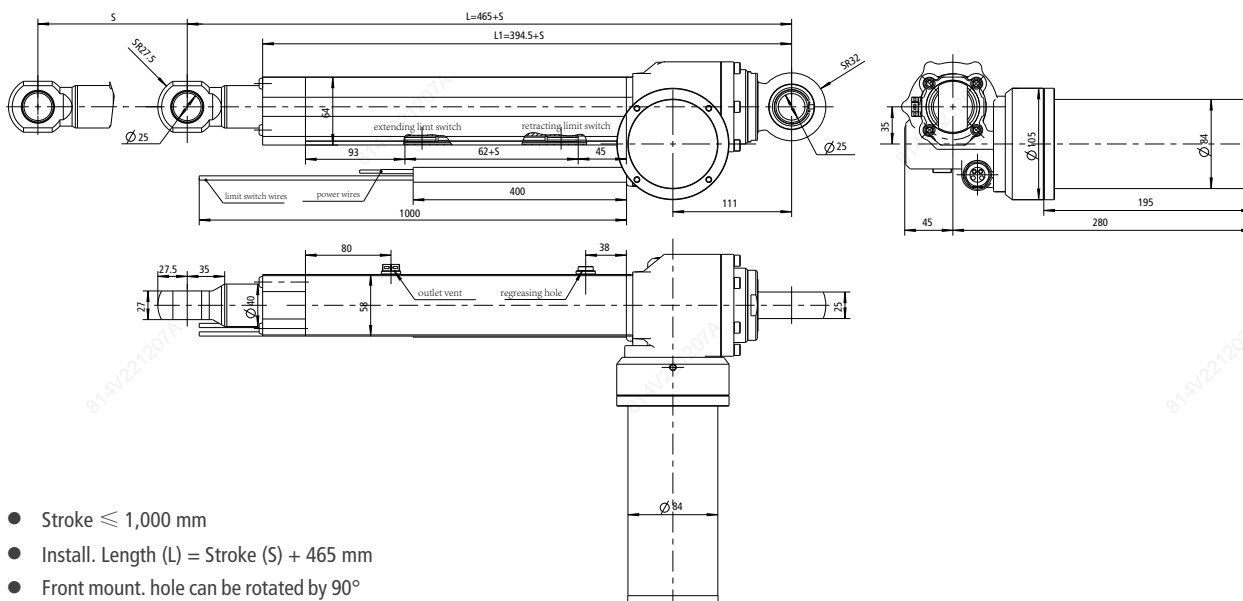

- Stroke  $\leq$  1,000 mm
- Install. Length (L) = Stroke (S) + 465 mm
- Front mount. hole can be rotated by 90°

## Inquiry Table

RESET

<input style="width: 100%; height: 20px;" type="text"/>	Motor Type	1 = 24VDC    2 = 48VDC
<input style="width: 100%; height: 20px;" type="text"/>	Code	See Table 1
<input style="width: 100%; height: 20px;" type="text"/>	Stroke (mm)	≤ 1,000 mm
<input style="width: 100%; height: 20px;" type="text"/>	Install. Length (mm)	Stroke + 465mm
<input style="width: 100%; height: 20px;" type="text"/>	Front Mount. End	F01 = Thru. hole $\varnothing$ 25    FX = Custom
<input style="width: 100%; height: 20px;" type="text"/>	Rear Mount. End	R01 = Ball joint $\varnothing$ 25    RX = Custom
<input style="width: 100%; height: 20px;" type="text"/>	Mount. Hole Direction	Front 1 = 0°    2 = 90°
<input style="width: 100%; height: 20px;" type="text"/>		Rear 1 = 0°    2 = 90°
<input style="width: 100%; height: 20px;" type="text"/>	Lead Screw	1 = Ball Screw
<input style="width: 100%; height: 20px;" type="text"/>	Cable Length	1 = 400mm    2 = 1000mm    X = Custom
<input style="width: 100%; height: 20px;" type="text"/>	Connector	0 = Tinned bared wires    X = Custom
Application	Working Frequency	Estimated cycles work per day
	End Use	Indoor or outdoor, and please describe your end use.
	Your Contact	Company Name Tel. <span style="float: right;">Email</span>

### Terms of Use

Due to our continuous improving of HB products, Hongba reserves the right to change or modify our products without prior notice, at any time. Therefore, Hongba cannot guarantee the correct and actual status of said information on its products. The user is responsible for determining the suitability of HB products for specific application.

Wuxi Hongba Mechanical Electrical Equipment. Co., Ltd.

Cell:

Email:

Tel.: 0510-85436730

Website: hbactuator.com

Address: 5 Lijiang Rd. Xinwu District, Wuxi 214028 China