



Constant Current Dimmable Driver

Model:PC42W300-1050CG



Model	Output Current	Input Current	Input Power	Output Power Range	PF	Efficiency	Output Voltage	No load Voltage
PC42W300-1050CG	300mA	0.10A	15W	3-12.6W	0.7C	82%	10-42V	55V
	350mA	0.11A	18W	3.5-14.7W	0.75C	84%	10-42V	55V
	400mA	0.12A	20W	4.0-16.8W	0.80C	86%	10-42V	55V
	450mA	0.13A	22W	4.5-18.9W	0.85C	86%	10-42V	55V
	500mA	0.14A	25W	5.0-21W	0.88C	86%	10-42V	55V
	550mA	0.15A	28W	5.5-23.1W	0.90C	87%	10-42V	55V
	600mA	0.16A	30W	6.0-25.2W	0.92C	87%	10-42V	55V
	650mA	0.17A	32W	6.5-27.3W		87%	10-42V	55V
	700mA	0.18A	34W	7.0-29.4W		88%	10-42V	55V
	750mA	0.19A	36W	7.5-31.5W		88%	10-42V	55V
	800mA	0.20A	39W	8.0-33.6W		88%	10-42V	55V
	850mA	0.21A	41W	8.5-34.0W	0.95	88%	10-40V	55V
	900mA	0.22A	43W	9.0-36W		88%	10-40V	55V
	950mA	0.23A	45W	9.5-38W		88%	10-40V	55V
	1000mA	0.24A	48W	10-40W		88%	10-40V	55V
1050mA	0.25A	50W	10.5-42W	88%		10-40V	55V	

* Test result @230V, 50Hz, Full Load.

1. Parameters

Category	Item	Technical Norm
Features	Output Type	Constant Current
	Dimming Type	Bluetooth/ZigBee
	Dimming range	1%-100%
	Output Features	Isolation
	IP Grade	IP20
	Insulation Class	Class II
Input	Rated Input Voltage	220-240VAC@300-1050mA
	Range of Input Voltage	176-264VAC or 176-280VDC@300-1050mA

	Frequency	50/60Hz
	Input Current	≤0.25A(230VAC, full load)
	Input Power	≤50W(230VAC, full load)
	Power Factor	≥0.95 (230VAC, full load)
	THD	≤20%(230VAC, full load)
	No-load Power Consumption	≤0.5W @230VAC (Dim to off)
	Inrush Current:	≤30A/2.8us (230VAC, full load)
Output	Output Voltage Range	10-42VDC@300-800mA
		10-40VDC@850-1050mA
	No Load Voltage	55VDC Max.
	Output Current	300 -1050mA (Max. output)
	Max. Output Power	42W
	Efficiency	≥87%(230VAC, full load)
	Current Ripple(< 120 Hz)	±5%(230VAC, full load)
	PstLM	≤1
	SVM	≤0.4
	Current Accuracy	±5%
Started Delay Time	≤0.5S (230VAC, full load)	
Protection	Short Circuit Protection	Auto Recovery
	Overload Protection	Auto Recovery
	No-load Protection	Auto Recovery
	Insulation voltage	3000V 5mA 60S between P-S
	Insulation resistance	>100M ohm @ 500VDC
	Leakage current	< 250μA, I/P to O/P or I/P to PE @230V input
Environment	Ta/Operation Temperature	-25....+50 °C
	Ts/Storage Temperature	-30....+85 °C
	Tc/Enclosure Temperature	85 °C
	Humidity	10%....90%RH
	Atmosphere	86-108KPa
Construction	Connection Method	Push-in Terminal
	Installation	Independent
	PRI Wire preparation	0.75-1.5 [□]
	SEC Wire preparation	0.75-1.5 [□]
	Dimension	118.5*67*22mm (L*W*H)
Standards	Certification	complied to CE ENEC
	Safety Standards	EN61347-1:2015 EN61347-2-13:2014/A1:2017 EN62384:2006/A1:2009
	EMC Standards	EN IEC 55015:2019 EN IEC 55015:2019/A11:2019 EN IEC 61000-3-2:2019 EN 61000-3-3:2013/A1:2019 EN61547:2009
	Performance	EN62384
	Surge	L-N/2KV
Others	RoHS	complied to 2011/65/EU

Life Time	50000h @ Ta / Tc
Warranty	5years , F.R. < 10000ppm

Remark:

- 1.All Parameters, if not specified, are measured at 230VAC/50Hz and 25°C ambient temperature.
- 2.LED Driver is a component of the luminaires, Luminaires and wire layout will affect the EMC, please check the EMC with end products again.

2. Output Current Setting

Output Current	1	2	3	4
300mA	-	-	-	-
350mA	-	-	-	ON
400mA	-	-	ON	-
450mA	-	-	ON	ON
500mA	-	ON	-	-
550mA	-	ON	-	ON
600mA	-	ON	ON	-
650mA	-	ON	ON	ON
700mA	ON	-	-	-
750mA	ON	-	-	ON
800mA	ON	-	ON	-
850mA	ON	-	ON	ON
900mA	ON	ON	-	-
950mA	ON	ON	-	ON
1000mA	ON	ON	ON	-
1050mA	ON	ON	ON	ON

3. Connected quantities of different current Breaker

TYPE	Connected quantities of different current Breaker						Input Voltage	Inrush Current	Time
	current (A)	10	13	16	20	25			
	Installation wire diameter	1.5mm ²	2.5mm ²	2.5mm ²	4mm ²	4mm ²			
TYPE B	20	26	32	40	50	@230VAC	30	2.8us	
TYPE C	32	42	51	64	80				
TYPE D	51	67	82	102	128				





4. Label



KGP Electronics GmbH
Hueckstraße 19
DE-58511 Lüdenscheid

LED Dimmable Driver
MODEL:PC42W300-1050CG
PRI: 220-240VAC 50/60Hz Max.0.25A
SEC: No load:5VDC Max.42W
Constant Current Type for LED Only
ta:50°C tc:85°C

Iin (A)	λ	Uo(VDC)	Po(W)	Io(mA)	1	2	3	4
0.10	0.70C		12.6	300	-	-	-	-
0.11	0.75C		14.7	350	-	-	-	ON
0.12	0.80C		16.8	400	-	-	ON	-
0.13	0.85C		18.9	450	-	-	ON	ON
0.14	0.88C		21	500	-	ON	-	-
0.15	0.90C	10-42	23.1	550	-	ON	-	ON
0.16			25.2	600	-	ON	ON	-
0.17			27.3	650	-	ON	ON	ON
0.18	0.92C	10-42	29.4	700	ON	-	-	-
0.19			31.5	750	ON	-	-	ON
0.20			33.6	800	ON	-	ON	-
0.21			34	850	ON	-	ON	ON
0.22			36	900	ON	ON	-	-
0.23	0.95	10-40	38	950	ON	ON	-	-
0.24			40	1000	ON	ON	ON	-
0.25			42	1050	ON	ON	ON	ON

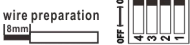

 wire preparation (8mm)

 PRI: 0.75-1.6°

 SEC: 0.5-1.5°

SEC 300-1050mA

 PRI 220-240VAC

 L N

CC-Bluetooth(S)
Meshle

CC-Zigbee(S)
Tuya

CC-Bluetooth(S)
Tuya

CC-Bluetooth(S)
CASAMBI

CC-Bluetooth(S)
Tmall

5. Lifetime curve

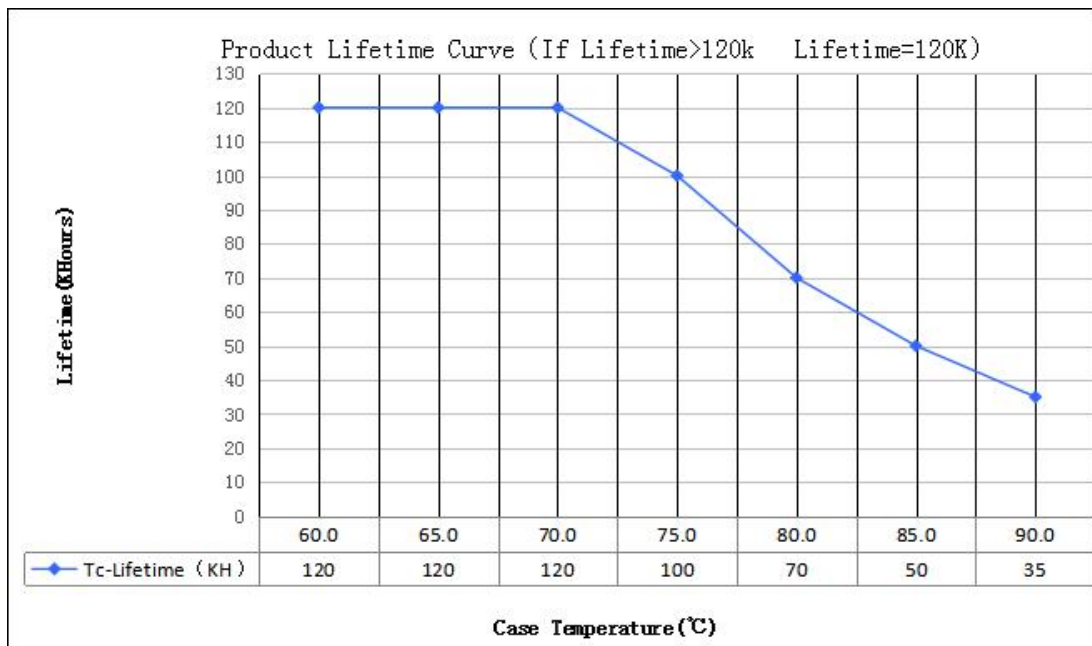

6. Dimension (Unit: mm)

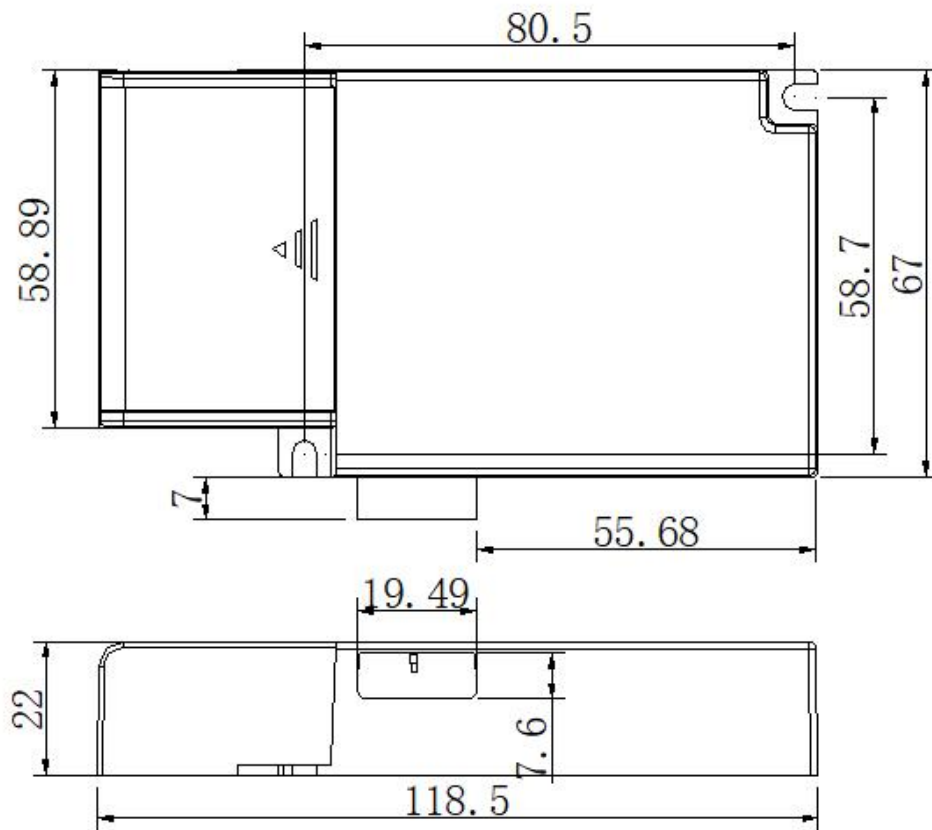

7. Packing information

packing way	Carton L*W*H(mm)	Pcs/Carton	Net weight/ Pcs(kg)	Net weight/ Carton(kg)	Gross weight / Carton(kg)
With white box and manual	450*240*200	65	0.16	10.4	10.92
Without white box and manual		90	0.146	13.14	13.84

8. Wiring Diagram

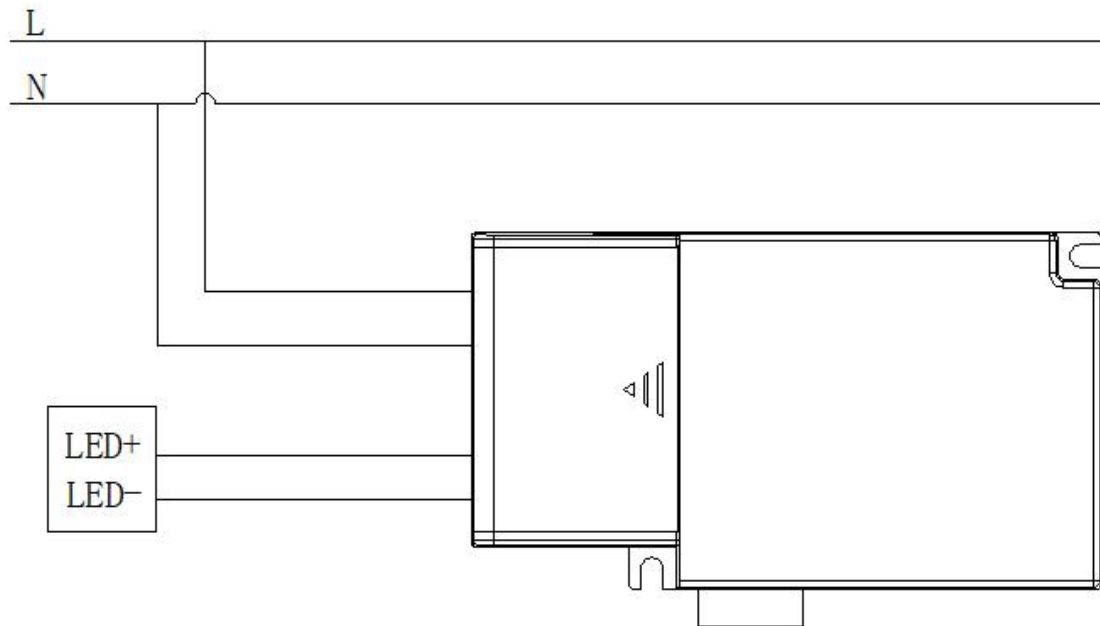

9. Wiring instructions

- All connections must be kept as short as possible to ensure good EMI behaviour
- Mains leads should be kept apart from LED Driver and other leads (ideally 5 – 10 cm distance)
- Advice the maximum length of output wires is 3 m
- Secondary switching is not permitted (Except for constant voltage)
- Incorrect wiring can damage LED modules.
- The wiring must be protected against short circuits to earth (sharp edged metals parts, metal cable clips, louver, etc.)