

REVISION RECORD				
REV	ECN	DESCRIPTION	DRFT	DATE
A0		NEW		21.11.16

NOTES1:
 UL Standard
 1. Rated voltage/current : 600V / 40A
 2. Withstanding voltage : AC2000V/1Min.
 3. Torque value : M4 , 9.7Lb.in
 4. Wire range : 18~10AWG

IEC Standard

1. Pollution degree	2
Overvoltage category	II
Rate impulse voltage(KV)	7KV
Rate voltage(V)	750V
Rate current(A)	40A

2. Torque value : M4 , 11kg.f
 3. Wire range : 2.5mm²/6mm²(sol)

NOTES2:
 1. Dimension shall be interpreted per ASME Y14.5-2009
 2. Pitch : 13.0mm, Poles : N=02~24P
 3. Operating temperature: -40°C~+105°C
 4. Undimensioned tolerances:

Pitch range in mm	Nominal dimension range in mm					
	Over 6	Over 10	Over 30	Over 60	Over 100	Over 150
TO 6	TO 10	TO 30	TO 60	TO 100	TO 150	0.1/10
±0.15	±0.20	±0.30	±0.30	±0.50	±0.70	±1.00
						±1.30
						±2'

6. RoHS Compliance

Ordering Information

JL13CM - 130 XX B 01

Pitch 130=13.0PH
 No. of pins 2P~24P
 Housing Color
 B=Black
 G=Green
 U=Blue
 R=Red
 W=White
 Y=Yellow
 O=Orange
 E=Grey

Packing
 O=Pe bag
 T=Tube
 A=Troy

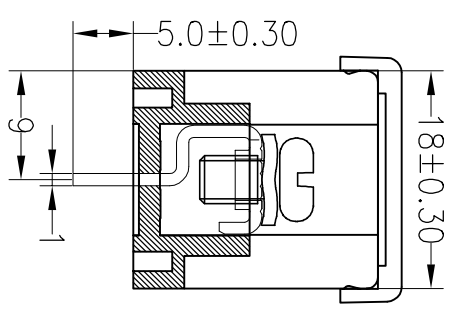
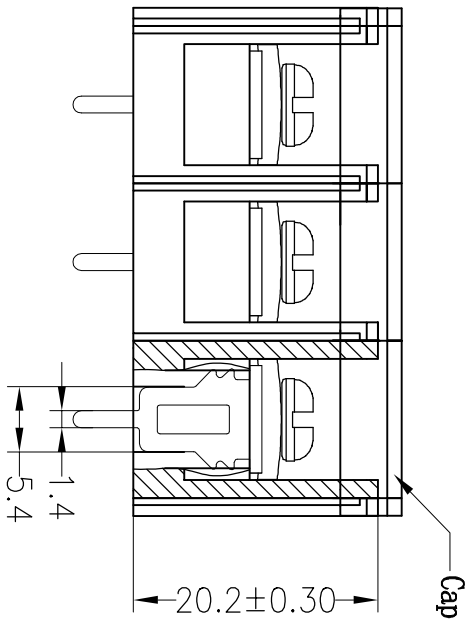
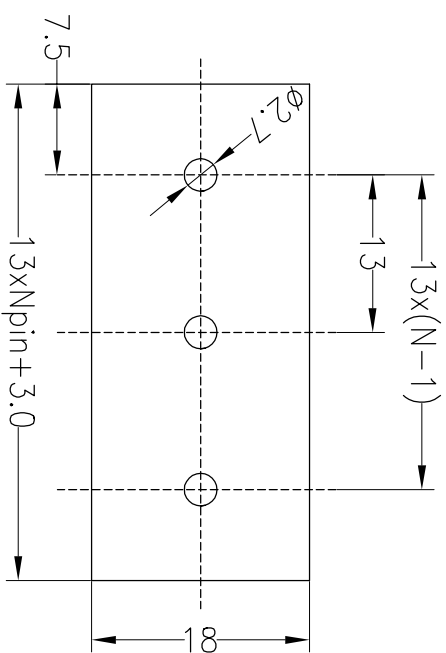
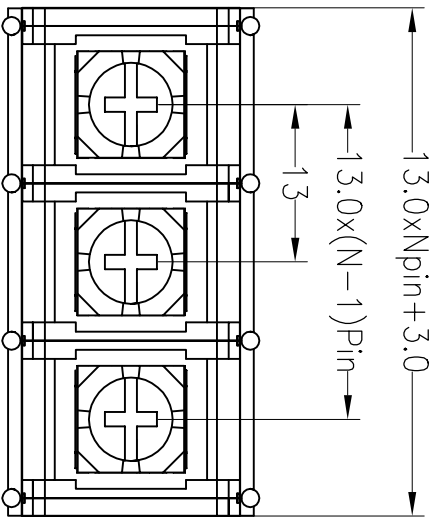

深圳扬讯电子有限公司

DRAW	SHUANGPING ZHENG
CHECK	LICHAO LIU
APPROVE	YONGLIANG GAO

SCALE	FIT
UNIT	mm
SIZE	A4
SHEET	1/1
PROJ.	

PART NO.	JL13CM-130XXB01
TITLE:	JL13CM-XXP 栅栏式端子台/PA66/黑色