

**h2ofloss**  
Whitening Tablets

Usage Guidelines

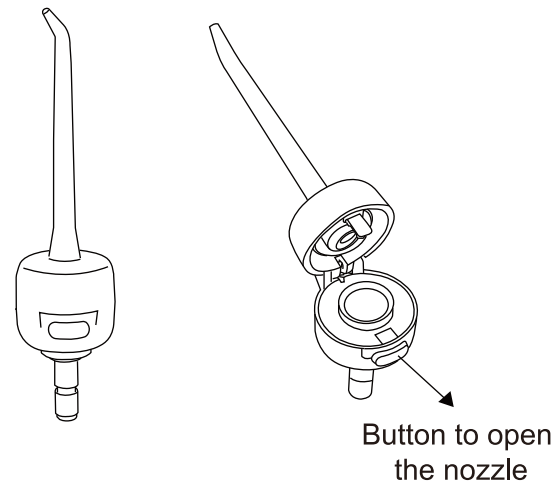

1. Upon receiving the product, please familiarize yourself with the product by referring to the picture below. If you have any questions, you can consult the seller at any time.



- 01 -

2. Take out a tablet and install it into the nozzle.

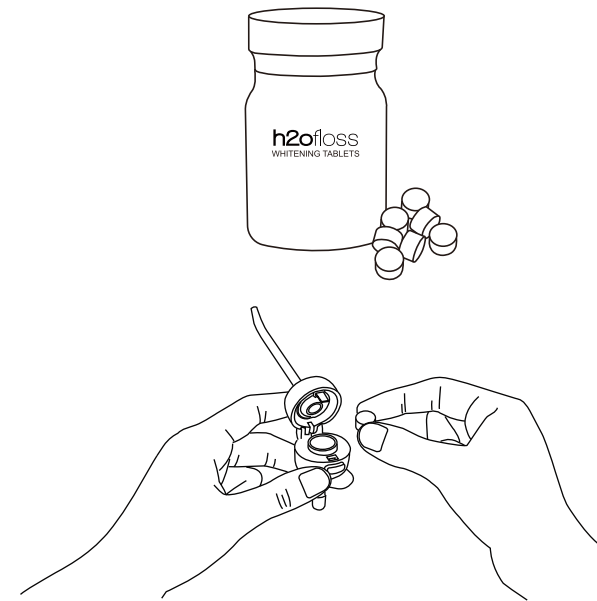

- 02 -

3. Close the nozzle and install it on the water flosser.



- 03 -

4. After flossing, please wash the nozzle with running water to remove residues.

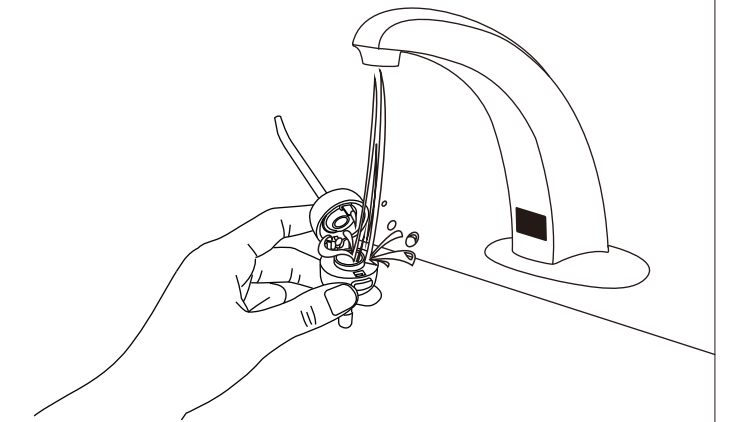

- 04 -

**Precautions for tablet use:**

1. For use only with water flosser equipped with a tablet nozzle.
2. Do not use if safety seal is broken.
3. Immediately close the medicine bottle cap after taking out the tablet, and use it up as soon as possible to avoid moisture absorption.
4. Use with caution for pregnant women and children under 6 years old.
5. Keep out of reach of children and pets.
6. Storage conditions: keep in dry and cool place.
7. Do not place tablet in reservoir.

- 05 -

**Precautions for nozzle use:**

Please do not use if damaged upon receipt. Please contact after-sales service for a replacement.

The nozzle is a consumable item and it is recommended to replace it every three months. After use, try to keep the interior dry as much as possible. Turn on the button and pour out any remaining moisture.

- 06 -

**1. The HF nozzle is only applicable to all Water Flosser models under the h2ofloss brand.**

**2. The WP nozzle is Compatible with MOST WATERPIK Models**

- Aquarius (WP-660, WP-662, WP-663, WP-665, WP-667, WP-668, WP-669)
- Aquarius Professional (WP-670, WP-672, WP-673, WP-674, WP-675, WP-676)
- Complete Care (WP-900)
- Complete Care 5.0 (WP-861, WP-862)
- Complete Care 5.5 (WP-811, WP-812)
- Complete Care 7.0 (WP-950, WP-952)
- Complete Care 9.0 (CC-01CD010-1, CC-01CD012-2)
- Complete Care 9.5 (CC-02CD010-1, CC-02CD012-2)
- Cordless Advanced (WP-560, WP-562, WP-563, WP-565, WP-567, WP-569)

- 07 -

- Cordless Select (WF-10W010, WF-10W012)
- Cordless Plus (WP-450, WP-462, WP-463, WP-465, WP-468)
- Cordless Freedom (WF-03CD010, WF-03CD012)
- Cordless (WP-360)
- Cordless Express (WF-02W010, WF-02W012)
- Cordless Professional (WP-440)
- For Kids (WP-260)
- Nano (WP-310)
- Nano Plus (WP-320)
- Ortho Care (WP-940)
- Radiance (WF-09CD010-1)
- Traveler (WP-300)
- Ultra (WP-100, WP-112, WP-113, WP-115, WP-117, WP-118, WP-140)
- Ultra Plus (WP-150)

- 08 -

Manufacturer: Shenzhen Baofengtong Electrical Appliance Manufacturing Co., Ltd

Address: 3rd floor, Building 10 Changxing Science and Technology Park Shayi Community Shajing Street Bao'an District, Shenzhen, China

Official Email: support@h2ofloss.com

Made in China

- 09 -