

h2ofloss

Oral Irrigator

Model: hf-9whisper

CONGRATULATION!

Thank you for selecting the h2ofloss oral and nasal irrigator.

The h2ofloss oral irrigator cleanses your teeth and gums, removing food particles from between your teeth and reducing bacteria that can lead to gingivitis and other periodontal diseases.

The h2ofloss nasal irrigator effectively cleanses and clear your sinuses gently and pleasantly, removing foreign matter, crusts and other undesirable materials, and massage the cilia and nose and sinuses to their normal, healthy state.

To maximize your benefit from the h2ofloss oral and nasal irrigator, it is important that you read and understand the information in this instruction manual.

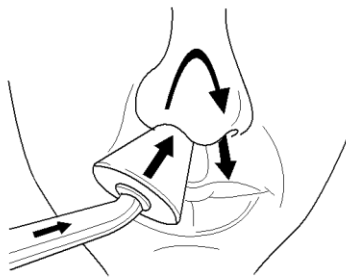

CONTENTS

Safety	4-5
Features	6-7
Operation	8-15
Maintenance	16
Troubleshooting	17
Warranty	18

SAFETY

When using electrical appliances, especially when children are present, precautions should always be followed, including, but not limited to the following:

READ ALL INSTRUCTIONS BEFORE USING.

DANGER:

To reduce the risk of electrocution:

- Always unplug this product immediately after use.
- Do not handle charger with wet hands.
- Do not place in or drop into water or other liquid.
- Periodically check the chord for damage.
- Do not use the unit while bathing.
- Do not place or store the unit where it can fall or be pulled into a tub, sink, or toilet.
- Do not reach for a unit that has fallen into water. Unplug immediately.

WARNING:

To reduce the risk of burns, electrocution, fire, or injury to persons:

- Do not plug this device into voltage system that is different from the voltage system specified on the device.
- Never operate this product if it has a damaged cord or plug, if it is not working properly, if dropped or damaged, or dropped into water.
- Close supervision is necessary when this product is used by, on or near children or adults requiring assistance.
- Do not direct water under the tongue, into the ear, nose or other delicate areas. This appliance is capable of producing pressures that may cause serious damage in these areas.
- Use this product only for it's intended use as described in the manual or as recommended by your dental professional.

- Do not use attachments not recommended by the manufacturer.
- Fill reservoir with warm water or other mouthwash or prescribed solution as recommended by your dental professional.
- Never drop or insert any object into any opening or hose.
- Do not use while wearing any oral jewelry. Remove prior to use.
- Do not use where oxygen or aerosol sprays are being administered.
- Do not add soda, salt or any other abrasive substance to the water in the reservoir as doing so will damage your h2ofloss.
- If you have had oral or periodontal surgery in the previous twelve months, contact your dentist prior to use.
- Do not use this product for more than 8 minutes in each two-hour period

SAVE THESE INSTRUCTIONS.

FEATURES

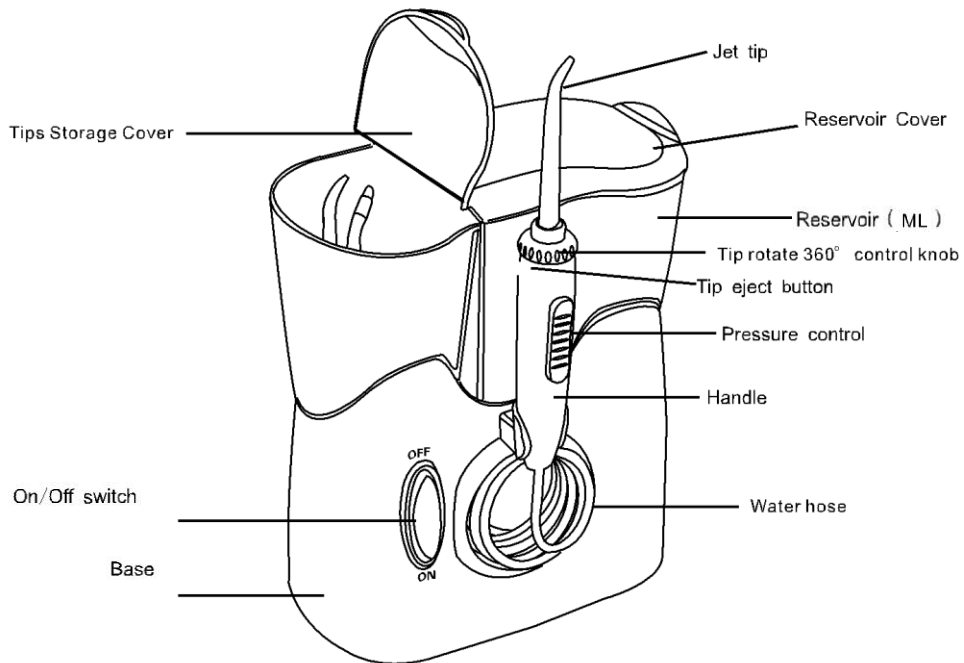

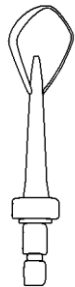

Tongue
Cleaner
Tip

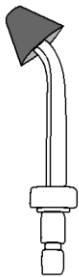

Standard Nasal
Irrigation Tip

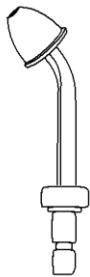

Moisturizing
Mist Spray
Nasal Tip

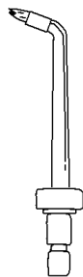

Orthodontic
Tip



Periodontal
Tip



Jet Tip

OPERATION

Plug this device into voltage system that is specified on the device. If the outlet is controlled by a wall switch, be sure it is turned on.

Tip Storage

The tip storage comes with two movable tips dividers. The holding capacity of tips is enlarged by removing the dividers. Max: 20 tips.

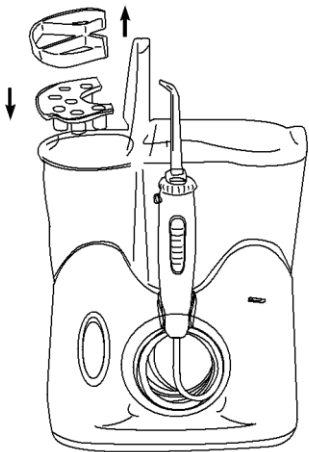

Preparing the Reservoir

Open the reservoir cover. Lift off the water reservoir from the base and fill with lukewarm water. Place the reservoir securely over the base and press down firmly. Put down the reservoir cover.

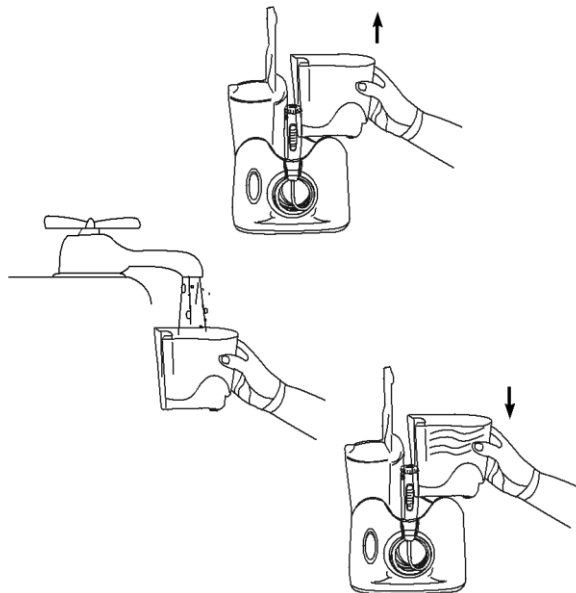

Inserting and Removing Tips

Insert jet tip firmly into the handle. When tip is correctly inserted there should be no gap between handle and the colored tip ring. To remove tip from the handle, press the tip eject button and pull tip from the handle.

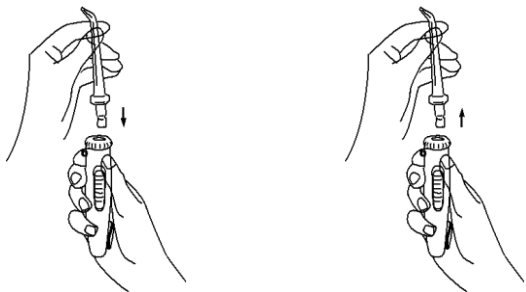

Adjusting the Pressure Setting

Direct the jet tip into the bottom of the sink basin and turn the on/off switch to the "on" position. As soon as water begins to flow from the jet tip, slide the pressure control knob to the setting that you intend to use, that is comfortable to you.

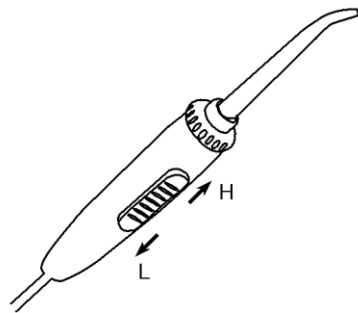

Placement in Mouth

Lean low over sink and place the jet tip in mouth. Aim the tip toward teeth.

With your free hand, turn the on/off switch on the base of the unit. Set pressure at desired setting.

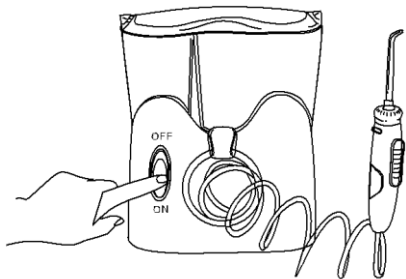

Direct the stream by turning the knob at the top of the handle.

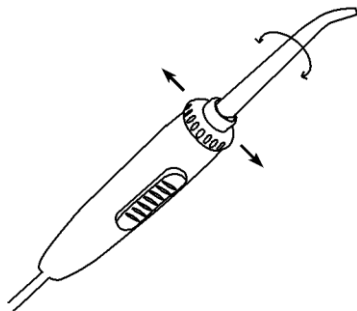

Recommended Technique

Bend over the sink and guide the jet to your teeth and gums. Glide the handle switch up to start the water stream. Keep your mouth slightly open to allow the water to run into the sink.

Direct the stream of water towards the gumline at 90 degrees, so that contact is made where the tooth and gums meet. Manoeuvre the flow of water from tooth to tooth remembering to pause briefly between each tooth.

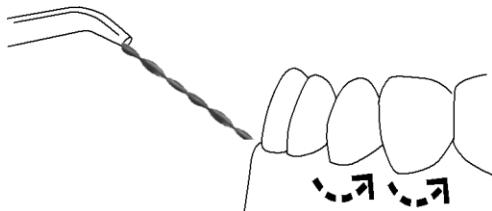

When Finished

Turn the unit off. Empty any water remaining in the reservoir after use. Unplug the unit.

SPECIAL TIPS

PERIODONTAL TIP

Place the periodontal tip in contact between teeth and the gumline. Lean the soft tip against a tooth at a 45-degree angle and gently place the tip under the gumline, into the pocket. Start the irrigator by setting it at the lowest pressure and clean by gently following gumline, inserting the periodontal tip in between teeth. Continue tracing along the gumline to massage the gums and safely deliver solution into the gingival pockets below the gumline.

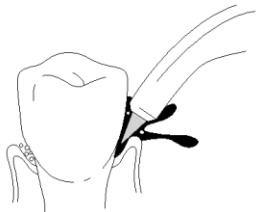

Tongue Cleaner Tip

Lean your head over the sink. Glide the pressure button to the lowest setting. Start the irrigator and place the tongue cleaner at the back of your tongue and move it forward to clean your tongue. Repeat to cover entire tongue. Set the pressure to the lowest setting and adjust to a higher setting for more water pressure as it feels comfortable.

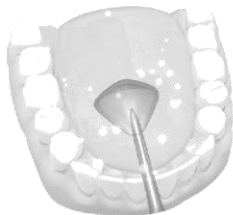

Orthodontic Tip

Use the Orthodontic Tip to simultaneously brush and rinse hard-to-reach areas around braces, crowns, bridges and implants. Start on the last molar (back tooth). Place tip at 90degree angle to the tooth at the gumline. Gently glide tip along gumline, pausing briefly to lightly brush area between teeth and all around orthodontic bracket, before proceeding to the next tooth and outside of both the upper and lower teeth. Continue process until you have cleaned the inside

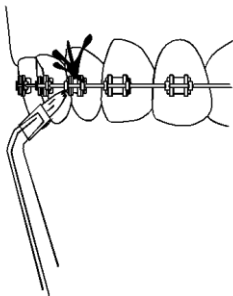

NASAL CLEANING SYSTEM

Pulsatile nasal/sinus irrigation is an extremely effective system for cleansing the nose and sinus, an effective tool for the maintenance of healthy nasal & sinus cilia.

IMPORTANT SAFEGUARDS TO AVOID INJURY:

- Follow your physician's instructions carefully when using this product.
- Closely supervise use by children and individuals with special needs.
- Do not use the h2ofloss nasal tip attachment anywhere except in nose.
- Do not use any other attachment in the nose except the h2ofloss nasal tip attachment.

WARNINGS:

- If you have an acute sinus infection, consult your doctor before using it.
- If you find yourself gagging or experience ear pain, you are trying to force too much solution into the

nasal passage too quickly.

- Coughing is normal as some of the solution may run down the back of the throat.

PREPARING RINSING SOLUTION:

For maximum comfort, use saline solution or doctor prescribed solution.

To make saline solution, use non-iodized or kosher, pickling, canning or sea salt. In a clean container, mix 1 teaspoon (0.22oz by weight) salt; 1/2 teaspoon (0.07oz by weight) of baking soda (sodium bicarbonate) with 8oz of lukewarm water. Dissolve salt thoroughly and pour into the reservoir.

DIRECTIONS FOR USE

- Insert the nasal jet tip into the opening on the handle. Push down firmly! Jet tip should snap into place.
- Position the soft nasal blue bulb over the sink, open end pointing upward.
- Turn "ON" the irrigator and glide the pressure setting to adjust the stream so that it is almost one inch high.

- Keep it at this pressure setting, switch 'OFF' the appliance.
- Insert the soft nasal blue bulb comfortably into the nose and turn "ON" the appliance.
- Lean over the sink so you can see the drain. In this position, none of the solution will go in your throat, and the treatment will be comfortable and pleasant.
- The solution will gently go in one side of the nose and out the other while stimulating nasal cilia and removing undesirable material. Continue rinse until liquid comes out clear.
- Remove nasal tip attachment from current nostril, place in other nostril and repeat process.
- Use about 50% of the mixed solution on each side of the nose.

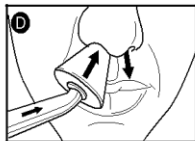
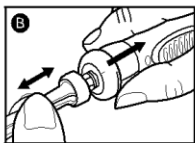
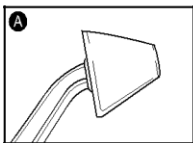

BENEFITS:

- When you rinse your nose with this salt water and baking soda mixture, it washes crusts and other debris from your nose.
- Salt water pulls fluid out of the swollen membranes of your nose. This decongests the nose and improves airflow. Not only does this make breathing easier, it helps open the sinus passages.
- Irrigating with saline solution helps the nose work better and moves mucus out of the nose faster.

MAINTENANCE

- Make sure to throw out the water inside the tank, and run the appliance for 2 to 3 seconds to drain the water after usage. Otherwise bacteria could collect in the remaining water.
- Do not submerge the unit in water or any other liquid.
- Wipe the exterior when necessary with a soft cloth and mild non-abrasive cleanser.
- Reservoir may be washed with soapy water. Before cleaning, unplug from the electrical outlet. Wash the dirt off from inside using a brush or similar, and wipe off with a cloth.
- Dry the reservoir when not using for a long period.

TROUBLESHOOTING

PROBLEM	CAUSE	CORRECTIVE ACTION
Jet Tips and Tongue Cleaner Leakage between the tip and handle knob	Tip not fully engaged	Remove tip and reinstall
PERIODONTAL Tip Tear in soft tip	Tip is worn	Replace with new tip
Base Hose to the handle leaks	Damage to the hose	Can be replaced by authorized service center or contact our company for a self service repair kit.
Reservoir leaks	Missing reservoir valve or reservoir valve is upside down.	Replace reservoir valve. Turn valve right-side up
Inadequate pressure	Reservoir not positioned properly	Re-position reservoir. Press down firmly on the reservoir.
Unit doesn't start	Motor not running	Be sure outlet is functioning: test with another appliance(check electrical reset button and/or wall switch)

WARRANTY

h2ofloss will repair or replace (at our option) your unit free of charge for 24 months from the date of purchase if the appliance is defective in workmanship or materials.

This guarantee does not cover: damage due to improper use, normal wear or use as well as defects that have a negligible effect on the value or operation of the appliance. The guarantee becomes void if repairs are undertaken by unauthorized persons and if original h2ofloss parts are not used.

To obtain service within the guarantee period, hand in or send the complete appliance with your purchase receipt to an authorized h2ofloss distributor/customer service center in your country. Purchaser is responsible for all postage and freight charges and any other expenses incidental to claiming against this Warranty.

h2ofloss

manufacturer : shenzhen baofengtong electrical
manufacturing co.,ltd

Made in China

Printed in China

<http://www.h2ofloss.net>
<http://www.h2ofloss.com>

Any questions, please contact Email: janet.lai@hotmail.com