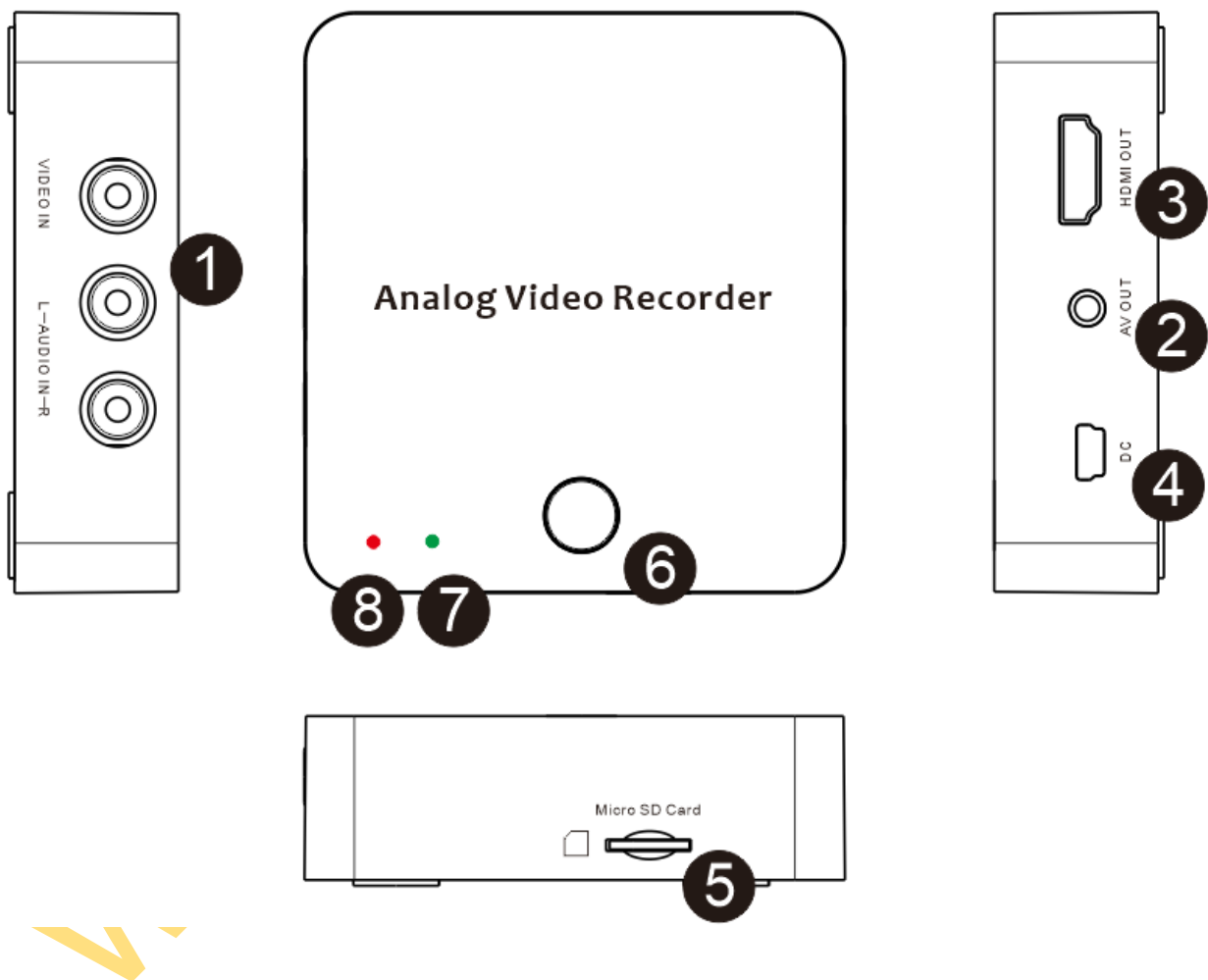

Analog Video Recorder

Quick Start Guide

Thanks for purchasing ezcap272 Analog Video Recorder. The following guides you how to set up. Hope this device will bring you nice digital experience.

With ezcap272 Analog Video Recorder, you can convert your old video tapes or camcorder tapes to digital format with one click of button, record and digitalize video from VHS, VCR's, DVD Players, DVR's, Camcorders, Hi8, and Gaming Systems. Ezcap272 Analog Video Recorder records video directly, no computer required.

Features:



1. VIDEO AUDIO IN – RCA Composite video and L/R audio input from video source device. Yellow = video, white = audio left channel, red = audio right channel.

2. AV OUT – Connect to TV monitor displaying with included AV Cable.

3. HDMI OUT –Connect to TV monitor displaying with HDMI Cable. (HDMI Cable is not included.)

4. DC – Connect to 5V DC power with mini USB cable. Or connect to computer's USB port to manage files or update firmware.

5. Micro SD card slot – Plug Micro SD card saving record file.
6. Record Button – Press to record video (even without video input), press again to stop and save file. Long time (about 3 seconds) press to switch PLAY mode and DATA mode.
7. PWR LED – It will light green when you connect DC power or computer's USB port.
8. REC LED – It will light red and flash when ezcap272 is recording.

Connections

VIDEO INPUT

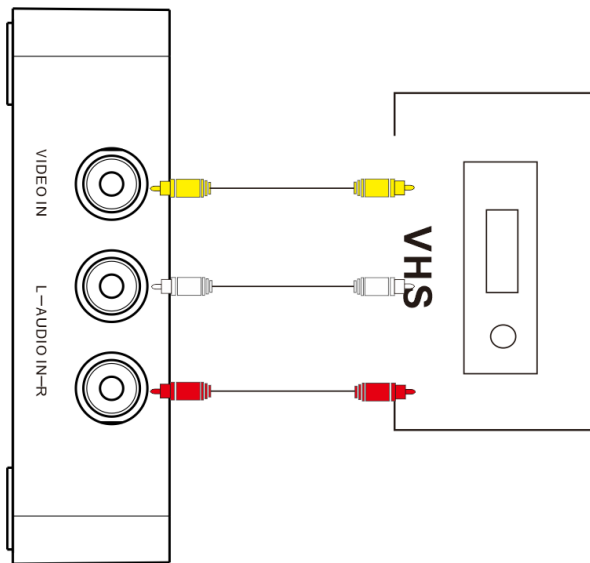

Use the RCA video audio cable (usually come with video source device included) to connect to the video source and INPUT VIDEO and L/R AUDIO of device.

The RCA connectors to VHS, yellow = video, white = audio left channel, red = audio right channel.

VIDEO OUTPUT

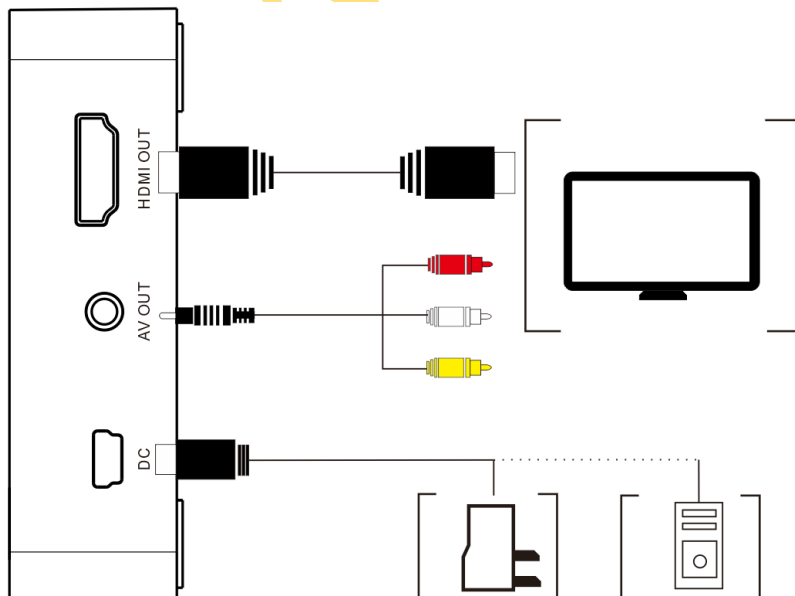

ezcap272 with two video output – HDMI OUT and AV OUT.

Use HDMI cable or 3.5MM to RCA cable (come with the device in box) to connect with HDMI OUT or AV OUT, and another side connects to TV or monitor.

TV or monitor will show the video if both of POWER DC, VIDEO INPUT and VIDEO OUTPUT are ready.

Don't connect HDMI and AV cable at same time.

If you connect HDMI and AV cable at same time, only AV OUT is effective. And HDMI OUT is useless even you pull AV cable out. You should pull HDMI out then push in again, then HDMI OUT is effective.

POWER AND DATA

Use USB cable to connect with 5V DC for play ezcap272 device.

Use USB cable to connect with computer's USB port for power or managing recorded files or updating firmware.

MICRO SD CARD

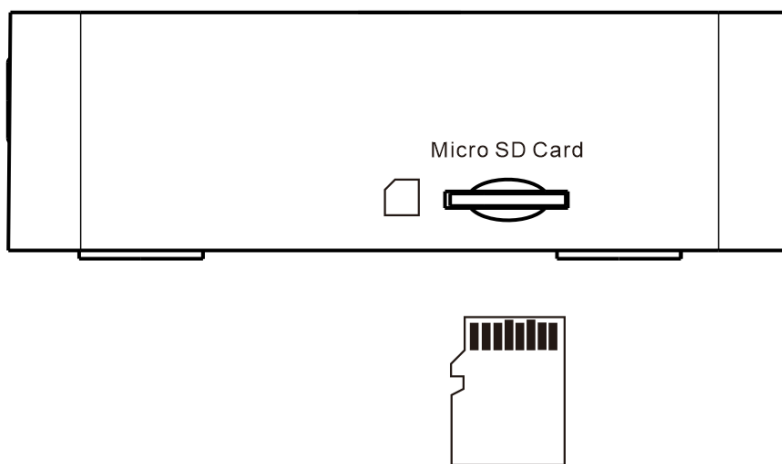

Plug Micro SD card into the slot with right direction, the TV or monitor screen will show "Card In" when plugged. And will show "Card Out" when remove Micro SD Card from device.

For file safety, Micro SD card better be empty and format before using, support FAT32 and exFAT, does not support NTFS, better 16GB.

To remove Micro SD card, just press it again, let it pop-up.

Operate:

RECORD VIDEO

You will preview the connecting video on TV or monitor when all connections are ready, press 'RECORD' button to record video, and REC red led will flash, it means it's recording. Press again to stop recording, led turns off, and show you "Saving File" on TV.

Image will show you "No Card Disk" if you don't insert Micro SD Card or insert the error card and press RECORD button. Please insert the Micro SD Card or check it.

Note: ezcap272 Analog Video Recorder will save a file and start to build another new file if you long time record more than 2 hours and 42 minutes.

SAVE FILES

You have two ways to save your recorded video files.

Connect DC port to computer's USB port with mini USB cable, then long press (about 3 seconds) RECORD button to

switch to DATA mode – will show you DATA and USB drive picture on screen, then you can find out the Micro SD Card disk on your computer. Open it, and find your recorded video files like ezcap0001.avi ... Copy them into your computer and play by media software. Long time press again will back to RECORD mode – will show you TVIN and preview video on screen.

Or, remove the Micro SD Card from device, and copy the recorded files from Micro SD Card to your computer or other digital devices.

SPECIFICATIONS:

Connection

Interface	USB 2.0
Video Input	RCA CVBS analogue video
Audio Input	RCA Analogue L/R audio
Video Output	CVBS analogue video by 3.5mm to 3RCA cable, HDMI
Audio Output	Analogue L/R audio by 3.5mm to 3RCA cable, HDMI

Applicable Connections

Video	Video Tape, Camcorder Tape, VHS, VCR, DVD Player, DVR, Hi8, Game Player ...
--------------	---

Hardware Extra

User Interface	RECORT Button
Others	Two indicator lights for power and record.
Dimensions	76(L) × 81(W) × 23(H) mm
Weight	70g

Package Contents

Device	ezcap272 Analog Video Recorder
Others	USB cable for power or data, 3.5mm to 3RCA cable for AVOUT, Manual, USB power adapter (option)

Specification

Storage Media	Supports extra Micro SD Card Max 16GB, doesn't support NTFS format
Record Format	.avi
Record Quality	480 30fps, PAL:720×576, NTSC: 720×480
Record File	About 9.3MB/Minute, 0.56GB/Hour.
Power Supply	5V/1A USB power

视频录制盒

说明手册

感谢购买 ezcap272 视频录制盒，请参考以下说明来设置和使用该产品，并愿这款产品带给你欣喜。

使用 ezcap272 视频录制盒，你可以将老式磁带录像机或老式磁带摄像机的视频转成数字格式保存，包括任何带有 CVBS 模拟视频输出的设备，都可以将视频录制为数字格式保存，包括 VHS，VCR，DVD，DVR，Hi8 和游戏机等。ezcap272 视频录制盒，无需电脑，直接录制视频。

Features:

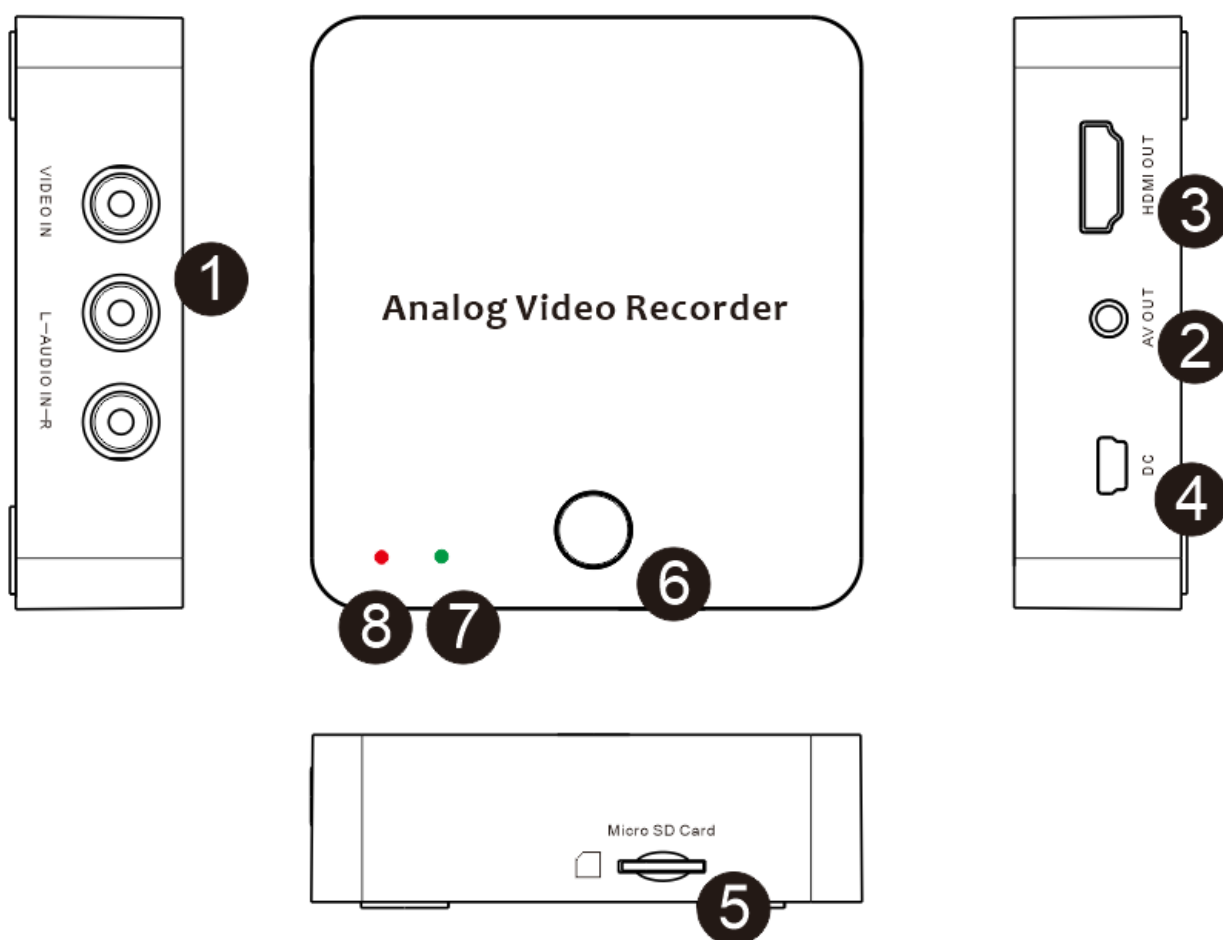

1. VIDEO AUDIO IN – 3RCA 莲花端子用于连接视频输入，黄色=AV，白色=左声道，红色=右声道

2. AV OUT –用配备的 AV 线材连接电视机

3. HDMI OUT – 用 HDMI 线材连接电视机或显示器

4. DC – 迷你 USB 接口，用于连接电源让机器工作，或连接电脑 USB 接口，将 TF 卡的文件拷贝到电脑，或更新软件程序。

5. TF 卡槽 – 插入 TF 卡来存储录制文件

6. 录制按键 – 按下开始录制视频，再按则停止录制并保存文件。 长按可以在录制视频和传输数据进行功能切换。

7. 电源指示灯 – 连接电源后绿色常亮

8. 录制指示灯 – 录制时红色闪烁，停止录制时熄灭

连接

视频输入

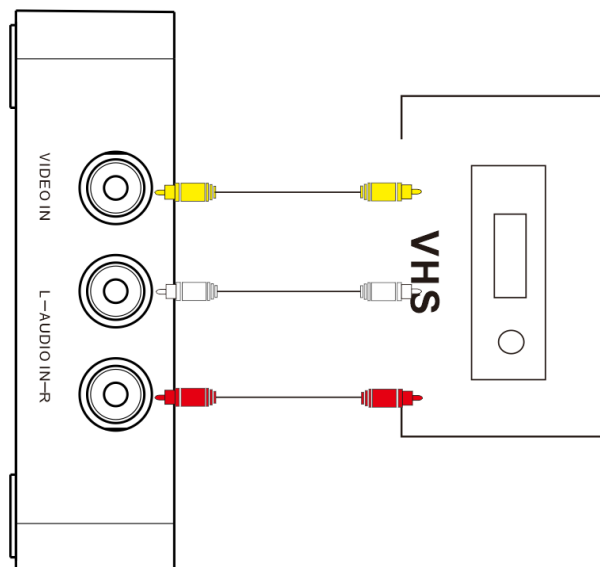

使用 3RCA 音视频连接线(一般视频源设备自带)连接 ezcap272 视频录制盒的音视频输入端口和视频源,如家庭录像机、磁带摄像机等。

连接视频源设备输出口,黄色-视频,红白-左右声道音频

视频输出

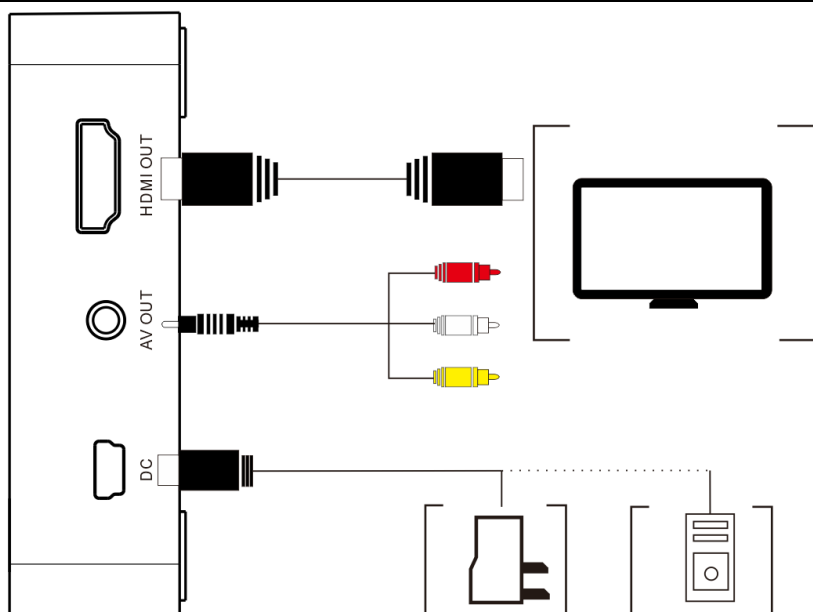

ezcap272 视频录制盒有两个视频输出方式 – HDMI 输出和 CVBS 视频输出。

用 HDMI 线连接 ezcap272 视频录制盒的 HDMI OUT 接口和电视机或显示器的 HDMI 输入接口，或者用附带的 3.5 毫米转 3RCA 线来连接 ezcap272 视频录制盒的 AV OUT 接口和电视机的三个莲花头视频输入接口。此时，视频将会在连接的电视机或显示器上显示。

请不要同时使用 HDMI OUT 和 AV OUT 来连接电视或显示器。

如果你同时连接了 HDMI OUT 和 AV OUT，那只有 AV OUT 有效。即使你此时拔出 AV OUT，HDMI OUT 也无效，只有重新插拔 HDMI OUT 后才可生效。

电源和数据传输

请使用附带的 USB 线和电源给机器供电以录制视频。

或用附带的 USB 线连接电脑 USB 接口用于供电，或拷贝录制文件到电脑，或用于程序升级。

TF 卡

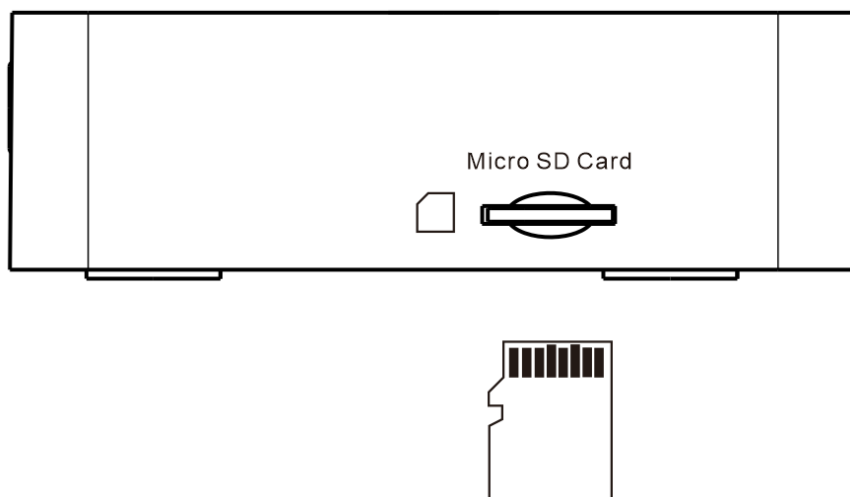

将 TF 卡按照正确方向插入机器卡槽，此时将会提示“Card In”。如果想取下 TF 卡，只需再次按下 TF 卡就会弹出来，退出卡时会提示“Card Out”。

为了录制文件的安全，使用前最好将 TF 卡清空并格式化。ezcap272 视频录制盒支持 FAT32 和 exFAT 格式，(不支持 NTFS 格式)，最大支持容量 16GB。

使用操作:

录制视频

以上全部连接准备好后, 你应该可以在电视机或者显示器上看到想要录制的视频。此时, 按下录制按键开始录制, 红色的录制指示灯会闪烁, 表示正在录制中。 再次按下录制键则停止录制并保存文件, 红色指示灯会熄灭, 画面也会提示"Saving File"。

如果你没有插入 TF 卡或者机器识别不到 TF 卡, 按下录制按键时, 画面会提示"No Card Disk", 请正确插入 TF 卡或检查你的 TF 卡是否有问题。

注意: 如果你长时间录制且超过 2 小时 42 分, ezc272 视频录制盒将会自动保存一个文件并开始下一段时间的录制并新建一个文件。

保存录制视频文件

你有两个方式来保存录制视频文件。

用附带的迷你 USB 线材连接设备和电脑, 长按录制键约 3 秒会从录制模式切换到数据模式 – 电视将会闪一下 DATA 字样后显示 U 盘图片, 这时可以在电脑上发现 TF 卡磁盘, 打开磁盘将会发现 ezc0001.avi 文件, 拷贝进电脑或用媒体播放软件播放。 再次长按录制键将会返回录制模式 – 电视会闪一下 TVIN 后显示视频。

或者, 可以取下 TF 卡, 并直接将卡里的文件拷贝到电脑或其它电子设备。

规格参数:

连接

界面	USB 2.0
视频输入	RCA CVBS 模拟视频
音频输入	RCA 模拟左右声道
视频输出	CVBS 模拟视频(通过附带 3.5 毫米转 3RCA 线连接), HDMI
音频输出	模拟左右声道(通过附带 3.5 毫米转 3RCA 线连接), HDMI

应用

视频	磁带放像机, 磁带摄像机, VHS, VCR, DVD, DVR, Hi8, 游戏机等
----	---

硬件

用户界面	录制按键
其它	电源和录制指示灯
尺寸	76(长) × 81(宽) × 23(高) 毫米
净重	70 克

包装内容

设备	ezc272 视频录制盒
其它	USB 线用于连接电源或传输数据, 3.5 毫米转 3RCA 线材用于连接 AV 输出, 说明书, USB 接口电源 (可选)

规格

存储媒介	外接 TF 卡, 最大支持 16GB, 不支持 NTFS 格式
录制格式	.avi
录制质量	480 30 帧, PAL:720×576, NTSC: 720×480

录制文件	大约 9.3MB/分钟, 0.56GB/小时。
电源适配器	5 伏/1 安 USB 电源

www.ezcap.com