



硬质合金棒材

CEMENTED CARBIDE ROD

www.jimsearbide.com



济南市冶金科学研究所

地址：中国山东济南市章丘圣井高科技园区
电话：0086-0531-82909067 Tel: 0086-531-87115542
传真：0086-0531-87100530 Fax: 0086-531-87115542
网址：www.chcarbide.com Http: www.jimsearbide.com
邮编：250220

济南市冶金科学研究所
JINAN INSTITUTE OF METALLURGICAL SCIENCE (JIMS)

企业简介

济南冶金科学研究所位于济南市章丘圣井高科技园区，是山东省认证的高新技术企业，是中国专业硬质合金生产基地之一，企业集科、工、贸于一体，具有自营进出口权，历经四十多年的发展，企业拥有了雄厚的研发能力和先进的生产设备。我所生产的“齐鲁牌”硬质合金及相关制品，广泛应用于机械、冶金、石油、矿山、建筑、电子、航天航空等领域，产品性能优良，品质卓越，在国内外市场享有很高的声誉。产品远销美国、加拿大、意大利、德国、日本、韩国、台湾等多个国家和地区，年出口创汇1000万美元，企业已通过ISO9001质量管理体系认证，并被评为一等AAA级信誉企业。

我所硬质合金制品种类齐全，可提供如下产品：

- 机械加工类焊接刀片、机夹刀片
- 矿用凿岩钎片、球齿、截齿；地质勘探、煤炭采掘工具
- 金刚石生产用顶锤
- 盾构刀具
- 建材加工用刀具
- 木工刀具
- 硬质合金圆棒、圆盘和板材
- 硬质合金轧辊、拉丝模
- 碳化钨粉及混合料

根据客户需要，可按国内、国际标准供货，也可承接各类异型产品的加工生产。热诚欢迎国内外客户惠顾。

Brief Introduction

Jinan Institute of Metallurgical Science (JIMS) is located in Shengjing Science and Technology Industrial Zone of Zhangqiu, Jinan, certificated as a high-tech enterprise by Shandong Province. JIMS is a specialized base of cemented carbide with scientific research, trade and manufacturing industry in a whole and with self-managing import-export power by the state of China, which assert sufficient ability of R&D, advanced equipment for production for more than 40 years development. The "QiLu" brand cemented carbide and relative products, which widely used in machinery, metallurgy, petroleum, mining, construction, electronics, aerospace and other fields, have excellent performance and high quality. JIMS products enjoy great famous both at home and abroad market, selling well in countries and areas like America, Canada, Italy, Germany, Japan, Korea and Taiwan etc. The annual foreign exchange we earn is more than 10 million U.S.D. JIMS has passed ISO9001 standard of the Quality Manage System Certificate of Conformity and be appraised the first class of the Enterprise Credit Certificate AAA.



We have a complete Variety and could supply the following cemented carbide products:

- Indexable inserts, mechanically clamped tips.
- Button bits, inserts and tips for mining, coal-cutting tools for coal-excavating.
- Cemented carbide anvil for the diamond industry.
- Cutting tools for woodwork (Rotary burs).
- Solid cemented carbide rod, disk and bar.
- Solid cemented carbide roll, drawing die.
- Cemented carbide powder and mixed powder.

We could supply the products according to the standard of ISO and the domestic; moreover, we could work according to the drawings from customers.

Welcome your patronage of domestic and overseas customers to our company!



硬质合金棒材牌号、性能及推荐用途

Performance and recommended application of cemented carbide grades



牌号 Grade	国际分类号 ISO	晶粒度 Grain size μm	Co含量 Cobalt content wt%	密度 Density g/cm ³	硬度 HRA	抗弯强度 N/mm ²	用途 Applications
JF10	K20-K30	0.6	10.0	14.45	91.5	3800	适用于加工碳钢、合金钢、铸铁、不锈钢、铝合金、镍基及钛合金等材料。
JF10A	K10-K20	0.6	10.0	14.45	92.0	4000	适用于加工普钢、铸铁、铝镁合金、钛合金、淬硬钢和纤维加强材料等。
JF06	K05-K10	0.6	6.0	14.90	92.5	3300	适用于加工铸铁、有色金属、木材、铝合金、铁基合金、塑料以及碳纤维等复合材料。
JF06A	K05-K10	0.6	6.0	14.90	93.0	3800	适用于加工淬硬钢、玻璃纤维、木材、塑料、铝镁合金等材料。
JU12	K10-K30	0.5	12.0	14.05	92.5	4000	适用于加工碳钢、钛合金、耐热合金、不锈钢、淬硬钢、灰口铸铁、玻璃纤维及其它复合材料等。
YG10X	K20-K30	0.8	10.0	14.45	91.0	3500	适用于加工普钢、铸铁、有色金属、铝合金等材料。

实心圆棒	C/F/B 1 2 3 4 5 6 7 8
C	圆棒
F	精磨
B	粗磨
1	直径尺寸十位数
2	直径尺寸个位数
3	直径尺寸小数点后第一位数
4	直径尺寸小数点后第二位数
5	长度尺寸百位数
6	长度尺寸十位数
7	长度尺寸个位数
8	长度尺寸小数点后第一位数。
单直孔圆棒	C/F/B 1 2 3 4 5 6 7 8 S 9 10
S	单直孔
9	小孔直径尺寸个位数
10	小孔直径尺寸小数点后第一位数
双直孔圆棒	C/F/B 1 2 3 4 5 6 7 8 D 9 10 11 12 13
D	双直孔
9	小孔直径尺寸个位数
10	小孔直径尺寸小数点后第一位数
11	孔间距尺寸十位数
12	孔间距尺寸个位数
13	孔间距尺寸小数点后第一位数

编号规则

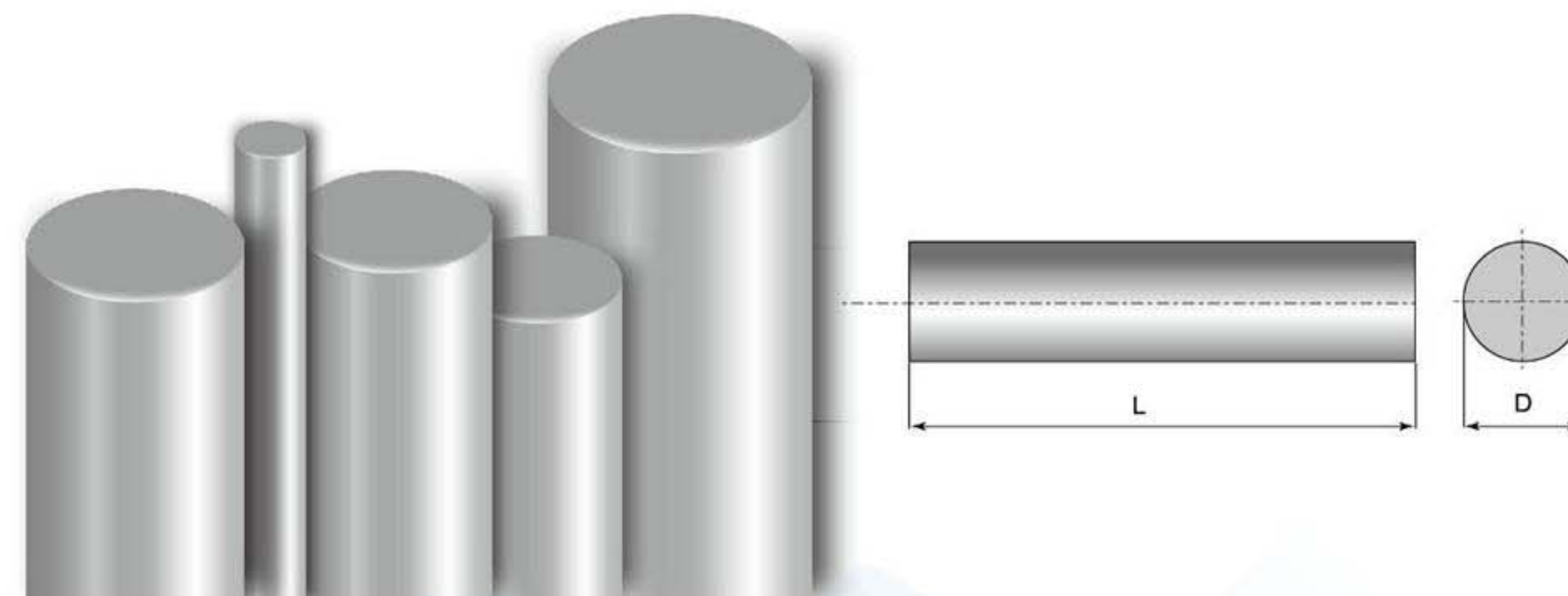

型号	直径公差(mm)	长度公差 (mm)
Type	Tol.of D(mm)	Tol.of L(mm)
CB02001000	+0.5/+0.3	+1/+0.5
CB02501000	+0.5/+0.3	+1/+0.5
CB03000500	+0.5/+0.3	+1/+0.5
CB03001000	+0.5/+0.3	+1/+0.5
CB03500520	+0.5/+0.3	+1/+0.5
CB04000500	+0.5/+0.3	+1/+0.5
CB04000750	+0.5/+0.3	+1/+0.5
CB04001000	+0.5/+0.3	+1/+0.5
CB05000500	+0.5/+0.3	+1/+0.5
CB05000860	+0.5/+0.3	+1/+0.5
CB05500660	+0.5/+0.3	+1/+0.5
CB05500930	+0.5/+0.3	+1/+0.5
CB05501500	+0.5/+0.3	+1/+0.5
CB06000500	+0.5/+0.3	+1/+0.5
CB06000570	+0.5/+0.3	+1/+0.5
CB06001000	+0.5/+0.3	+1/+0.5
CB06002000	+0.5/+0.3	+1/+0.5
CB06501550	+0.5/+0.3	+1/+0.5
CB07000700	+0.5/+0.3	+1/+0.5
CB07501090	+0.5/+0.3	+1/+0.5
CB08000600	+0.5/+0.3	+1/+0.5
CB08000700	+0.5/+0.3	+1/+0.5
CB08000800	+0.5/+0.3	+1/+0.5
CB08000930	+0.5/+0.3	+1/+0.5

注：尺寸单位均为mm，有特殊要求的另外注明



实心硬质合金棒材毛坯

Solid cemented carbide rod unground

实心硬质合金棒材毛坯

Solid cemented carbide rod unground

短棒系列

型号 Type	直径公差(mm) Tol.of D(mm)	长度公差 (mm) Tol.of L(mm)
CB08001000	+0.5/+0.3	+1/+0.5
CB08001200	+0.5/+0.3	+1/+0.5
CB08501200	+0.5/+0.3	+1/+0.5
CB09001270	+0.5/+0.3	+1/+0.5
CB09001450	+0.5/+0.3	+1/+0.5
CB09501350	+0.5/+0.3	+1/+0.5
CB10000600	+0.5/+0.3	+1/+0.5
CB10000650	+0.5/+0.3	+1/+0.5
CB10000700	+0.5/+0.3	+1/+0.5
CB10000750	+0.5/+0.3	+1/+0.5
CB10000890	+0.5/+0.3	+1/+0.5
CB10001000	+0.5/+0.3	+1/+0.5
CB10001150	+0.5/+0.3	+1/+0.5
CB10001400	+0.5/+0.3	+1/+0.5
CB10500950	+0.5/+0.3	+1/+0.5
CB11000700	+0.5/+0.3	+1/+0.5
CB11501420	+0.5/+0.3	+1/+0.5
CB12000600	+0.5/+0.3	+1/+0.5
CB12000700	+0.5/+0.3	+1/+0.5
CB12000750	+0.5/+0.3	+1/+0.5
CB12000900	+0.5/+0.3	+1/+0.5
CB12501000	+0.6/+0.4	+1/+0.5
CB12501510	+0.6/+0.4	+1/+0.5
CB13000750	+0.6/+0.4	+1/+0.5
CB13501200	+0.6/+0.4	+1/+0.5
CB14000700	+0.6/+0.4	+1/+0.5
CB14001000	+0.6/+0.4	+1/+0.5
CB14501000	+0.6/+0.4	+1/+0.5

型号 Type	直径公差(mm) Tol.of D(mm)	长度公差 (mm) Tol.of L(mm)
CB15001300	+0.6/+0.4	+1/+0.5
CB15501000	+0.7/+0.5	+1/+0.5
CB16000800	+0.7/+0.5	+1/+0.5
CB16001200	+0.7/+0.5	+1/+0.5
CB16001400	+0.7/+0.5	+1/+0.5
CB16501000	+0.7/+0.5	+1/+0.5
CB17001000	+0.7/+0.5	+1/+0.5
CB17501450	+0.7/+0.5	+1/+0.5
CB18001350	+0.7/+0.5	+1/+0.5
CB20001000	+0.7/+0.5	+1/+0.5
CB20001200	+0.7/+0.5	+1/+0.5
CB20501000	+0.7/+0.5	+1/+0.5
CB21001300	+0.7/+0.5	+1/+0.5
CB22001500	+0.7/+0.5	+1/+0.5
CB23001000	+0.7/+0.5	+1/+0.5
CB23501000	+0.7/+0.5	+1/+0.5
CB24001000	+0.7/+0.5	+1/+0.5
CB24501100	+0.7/+0.5	+1/+0.5
CB25001300	+0.7/+0.5	+1/+0.5
CB25501500	+0.7/+0.5	+1/+0.5
CB26001000	+0.7/+0.5	+1/+0.5
CB26501300	+0.7/+0.5	+1/+0.5
CB26501500	+0.7/+0.5	+1/+0.5
CB27001000	+0.7/+0.5	+1/+0.5
CB27501000	+0.7/+0.5	+1/+0.5
CB28001000	+0.7/+0.5	+1/+0.5
CB28501000	+0.7/+0.5	+1/+0.5
CB29001000	+0.7/+0.5	+1/+0.5
CB29501000	+0.7/+0.5	+1/+0.5
CB30001000	+0.7/+0.5	+1/+0.5
CB30001500	+0.7/+0.5	+1/+0.5
CB31501000	+0.7/+0.5	+1/+0.5
CB32001000	+0.7/+0.5	+1/+0.5
CB32001500	+0.7/+0.5	+1/+0.5

●可根据顾客的要求特殊订制
We can offer customized rods based on your various special requirements





实心硬质合金棒材毛坯

Solid cemented carbide rod unground

实心硬质合金棒材毛坯

Solid cemented carbide rod unground

长棒系列

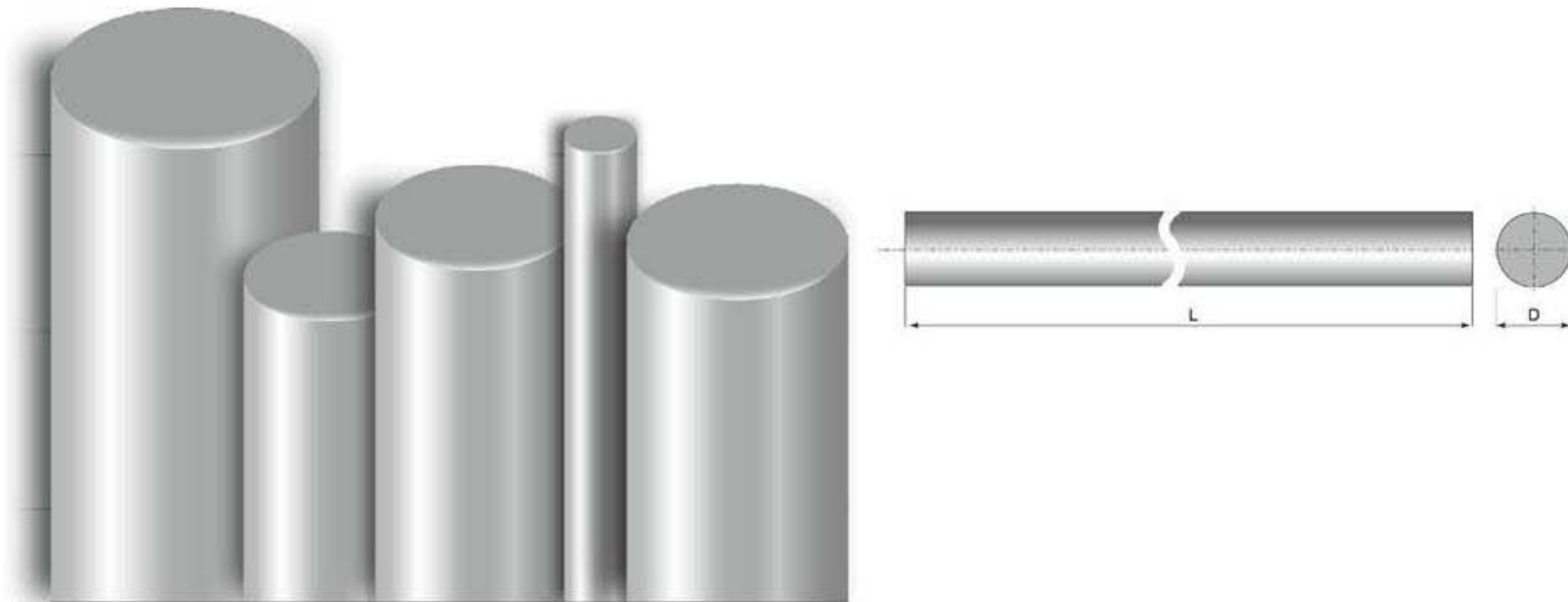

型号	直径公差(mm)	长度公差 (mm)	每100mm弯曲度 (mm)
Type	Tol.of D(mm)	Tol.of L(mm)	Cur.per 100 (mm)
CB02003300	+0.5/+0.3	+5/0	0.3
CB02503300	+0.5/+0.3	+5/0	0.3
CB03003300	+0.5/+0.3	+5/0	0.3
CB03503300	+0.5/+0.3	+5/0	0.3
CB04003300	+0.5/+0.3	+5/0	0.3
CB04503300	+0.5/+0.3	+5/0	0.3
CB05003300	+0.5/+0.3	+5/0	0.3
CB05503300	+0.5/+0.3	+5/0	0.3
CB06003300	+0.5/+0.3	+5/0	0.3
CB06503300	+0.5/+0.3	+5/0	0.3
CB07003300	+0.5/+0.3	+5/0	0.3
CB07503300	+0.5/+0.3	+5/0	0.3
CB08003300	+0.5/+0.3	+5/0	0.3
CB08503300	+0.5/+0.3	+5/0	0.3
CB09003300	+0.5/+0.3	+5/0	0.3
CB09503300	+0.5/+0.3	+5/0	0.3
CB10003300	+0.5/+0.3	+5/0	0.3
CB10503300	+0.5/+0.3	+5/0	0.3
CB11003300	+0.5/+0.3	+5/0	0.3
CB11503300	+0.5/+0.3	+5/0	0.3
CB12003300	+0.5/+0.3	+5/0	0.3
CB12503300	+0.6/+0.4	+5/0	0.3
CB13003300	+0.6/+0.4	+5/0	0.3
CB13503300	+0.6/+0.4	+5/0	0.3

型号	直径公差(mm)	长度公差 (mm)	每100mm弯曲度 (mm)
Type	Tol.of D(mm)	Tol.of L(mm)	Cur.per 100 (mm)
CB14003300	+0.6/+0.4	+5/0	0.3
CB15003300	+0.6/+0.4	+5/0	0.3
CB15503300	+0.7/+0.5	+5/0	0.3
CB16003300	+0.7/+0.5	+5/0	0.3
CB16503300	+0.7/+0.5	+5/0	0.3
CB17003300	+0.7/+0.5	+5/0	0.3
CB17503300	+0.7/+0.5	+5/0	0.3
CB18003300	+0.7/+0.5	+5/0	0.3
CB18503300	+0.7/+0.5	+5/0	0.3
CB19003300	+0.7/+0.5	+5/0	0.3
CB19503300	+0.7/+0.5	+5/0	0.3
CB20003300	+0.7/+0.5	+5/0	0.3
CB20503300	+0.7/+0.5	+5/0	0.3
CB21003300	+0.7/+0.5	+5/0	0.3
CB22003300	+0.7/+0.5	+5/0	0.3
CB22503300	+0.7/+0.5	+5/0	0.3
CB23003300	+0.7/+0.5	+5/0	0.3
CB23503300	+0.7/+0.5	+5/0	0.3
CB24003300	+0.7/+0.5	+5/0	0.3
CB25003300	+0.7/+0.5	+5/0	0.3
CB25503300	+0.7/+0.5	+5/0	0.3
CB26003300	+0.7/+0.5	+5/0	0.3
CB26503300	+0.7/+0.5	+5/0	0.3
CB27003300	+0.7/+0.5	+5/0	0.3
CB27503300	+0.7/+0.5	+5/0	0.3
CB28003300	+0.7/+0.5	+5/0	0.3
CB28503300	+0.7/+0.5	+5/0	0.3
CB29003300	+0.7/+0.5	+5/0	0.3
CB29503300	+0.7/+0.5	+5/0	0.3
CB30003300	+0.7/+0.5	+5/0	0.3
CB30503300	+0.7/+0.5	+5/0	0.3
CB31003300	+0.7/+0.5	+5/0	0.3
CB31503300	+0.7/+0.5	+5/0	0.3
CB32003300	+0.7/+0.5	+5/0	0.3

●可根据顾客的要求特殊订制
We can offer customized rods based on your various special requirements



单直孔硬质合金棒材毛坯

Cemented carbide rod unground with one straight coolant hole

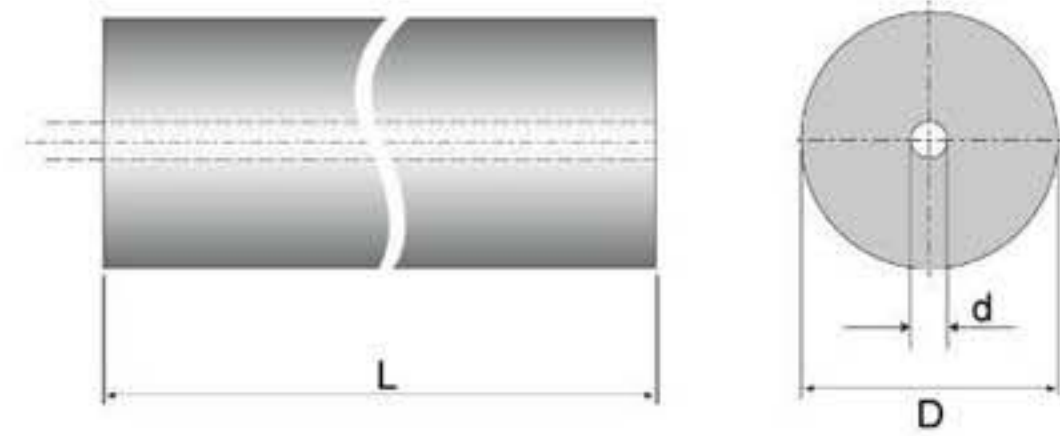
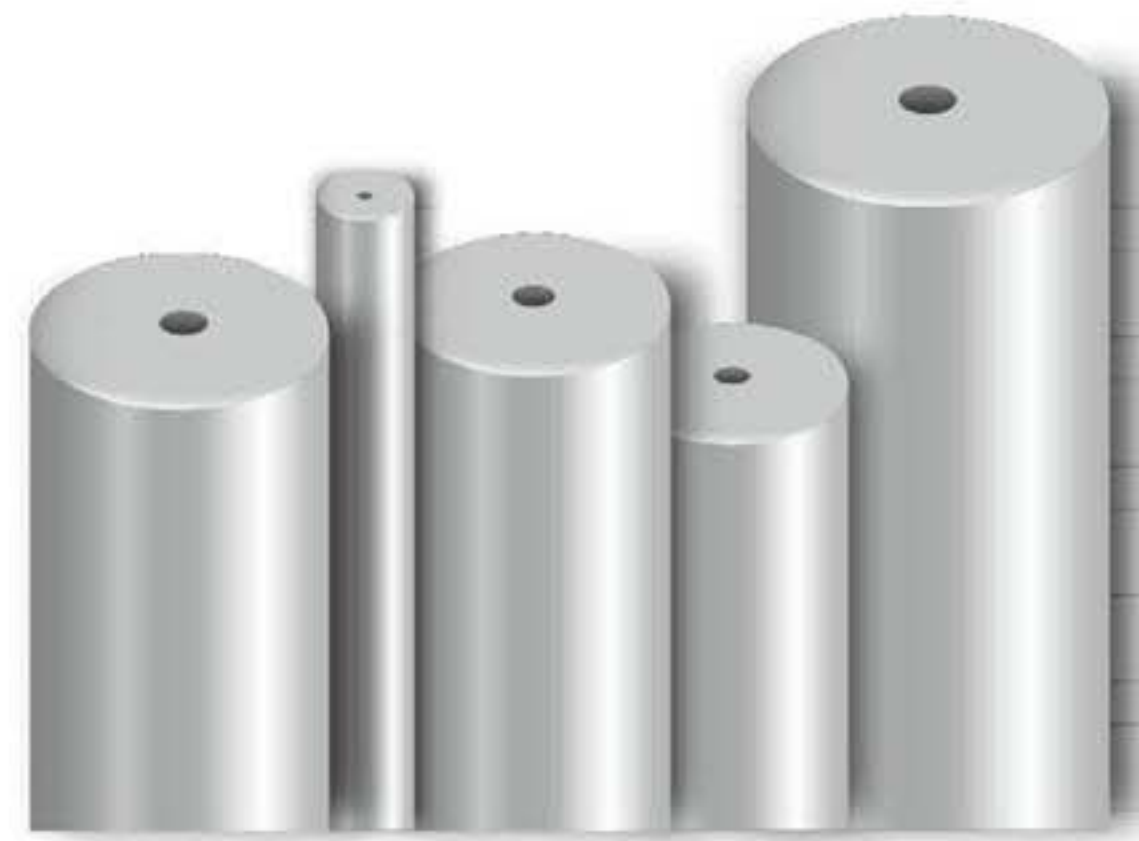

双直孔硬质合金棒材毛坯

Cemented carbide rod unground with two straight coolant holes

双孔系列

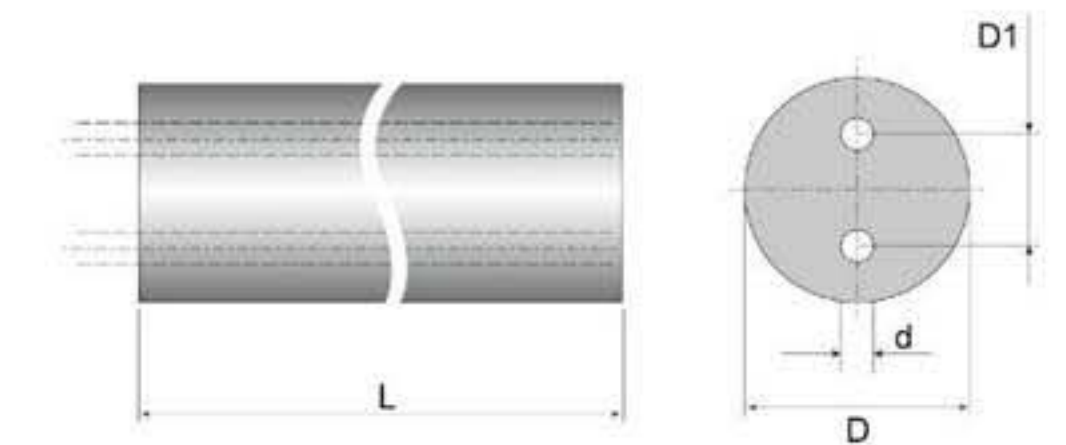

型号 Type	直径公差(mm) Tol.of D(mm)	内孔公差(mm) Tol.of d(mm)	长度公差 (mm) Tol.of L(mm)	每100mm弯曲度 (mm) Cur.per 100 (mm)
CB03003300S06	+0.5/+0.3	+0.15/-0.15	+5/0	0.3
CB04003300S08	+0.5/+0.3	+0.15/-0.15	+5/0	0.3
CB05003300S10	+0.5/+0.3	+0.15/-0.15	+5/0	0.3
CB06003300S10	+0.5/+0.3	+0.15/-0.15	+5/0	0.3
CB08003300S15	+0.5/+0.3	+0.15/-0.15	+5/0	0.3
CB10003300S20	+0.5/+0.3	+0.2/-0.2	+5/0	0.3
CB12003300S20	+0.5/+0.3	+0.2/-0.2	+5/0	0.3
CB14003300S20	+0.6/+0.4	+0.2/-0.2	+5/0	0.3
CB16003300S20	+0.7/+0.5	+0.2/-0.2	+5/0	0.3
CB18003300S30	+0.7/+0.5	+0.25/-0.25	+5/0	0.3
CB18003300S30	+0.7/+0.5	+0.25/-0.25	+5/0	0.3
CB20003300S30	+0.7/+0.5	+0.25/-0.25	+5/0	0.3
CB20003300S30	+0.7/+0.5	+0.25/-0.25	+5/0	0.3
CB22003300S30	+0.7/+0.5	+0.25/-0.25	+5/0	0.3
CB22003300S30	+0.7/+0.5	+0.25/-0.25	+5/0	0.3
CB23003300S30	+0.7/+0.5	+0.25/-0.25	+5/0	0.3
CB24003300S30	+0.7/+0.5	+0.25/-0.25	+5/0	0.3
CB25003300S30	+0.7/+0.5	+0.25/-0.25	+5/0	0.3
CB26003300S40	+0.7/+0.5	+0.25/-0.25	+5/0	0.3
CB27003300S40	+0.7/+0.5	+0.25/-0.25	+5/0	0.3
CB28003300S40	+0.7/+0.5	+0.25/-0.25	+5/0	0.3
CB29003300S40	+0.7/+0.5	+0.25/-0.25	+5/0	0.3
CB30003300S40	+0.7/+0.5	+0.25/-0.25	+5/0	0.3
CB31003300S50	+0.7/+0.5	+0.25/-0.25	+5/0	0.3
CB32003300S50	+0.7/+0.5	+0.25/-0.25	+5/0	0.3

型号 Type	直径公差(mm) Tol.of D(mm)	内孔公差(mm) Tol.of d(mm)	孔间距 (mm) A(mm)	长度公差 (mm) Tol.of L(mm)	每100mm弯曲度 (mm) Cur.per 100 (mm)
CB04003300D08018	+0.5/+0.3	+0.15/-0.15	+0.1/-0.1	+5/0	0.3
CB05003300D08020	+0.5/+0.3	+0.15/-0.15	+0.1/-0.1	+5/0	0.3
CB07003300D10035	+0.5/+0.3	+0.15/-0.15	+0.1/-0.1	+5/0	0.3
CB08003300D10040	+0.5/+0.3	+0.15/-0.15	+0.15/-0.15	+5/0	0.3
CB10003300D15050	+0.5/+0.3	+0.2/-0.2	+0.15/-0.15	+5/0	0.3
CB11003300D15050	+0.5/+0.3	+0.2/-0.2	+0.15/-0.15	+5/0	0.3
CB12003300D18060	+0.5/+0.3	+0.2/-0.2	+0.2/-0.2	+5/0	0.3
CB13003300D18060	+0.6/+0.4	+0.2/-0.2	+0.2/-0.2	+5/0	0.3
CB14003300D18070	+0.6/+0.4	+0.2/-0.2	+0.2/-0.2	+5/0	0.3
CB15003300D20070	+0.6/+0.4	+0.2/-0.2	+0.2/-0.2	+5/0	0.3
CB17003300D20080	+0.7/+0.5	+0.2/-0.2	+0.25/-0.25	+5/0	0.3
CB18003300D20080	+0.7/+0.5	+0.2/-0.2	+0.25/-0.25	+5/0	0.3
CB19003300D20090	+0.7/+0.5	+0.2/-0.2	+0.25/-0.25	+5/0	0.3
CB20003300D25100	+0.7/+0.5	+0.25/-0.25	+0.35/-0.35	+5/0	0.3
CB21003300D26100	+0.7/+0.5	+0.25/-0.25	+0.35/-0.35	+5/0	0.3
CB22003300D26110	+0.7/+0.5	+0.25/-0.25	+0.35/-0.35	+5/0	0.3
CB23003300D26110	+0.7/+0.5	+0.25/-0.25	+0.35/-0.35	+5/0	0.3
CB24003300D26110	+0.7/+0.5	+0.25/-0.25	+0.35/-0.35	+5/0	0.3
CB25003300D26110	+0.7/+0.5	+0.25/-0.25	+0.35/-0.35	+5/0	0.3
CB27003300D27120	+0.7/+0.5	+0.3/-0.3	+0.35/-0.35	+5/0	0.3
CB28003300D27120	+0.7/+0.5	+0.3/-0.3	+0.35/-0.35	+5/0	0.3
CB29003300D27120	+0.7/+0.5	+0.3/-0.3	+0.35/-0.35	+5/0	0.3
CB30003300D28130	+0.7/+0.5	+0.3/-0.3	+0.35/-0.35	+5/0	0.3
CB31003300D28130	+0.7/+0.5	+0.3/-0.3	+0.35/-0.35	+5/0	0.3
CB32003300D28130	+0.7/+0.5	+0.3/-0.3	+0.35/-0.35	+5/0	0.3

●可根据顾客的要求特殊订制
We can offer customized rods based on your various special requirements

●可根据顾客的要求特殊订制
We can offer customized rods based on your various special requirements



实心硬质合金精磨棒材

Solid cemented carbide ground rods

实心硬质合金精磨棒材

Solid cemented carbide ground rods

精磨短棒

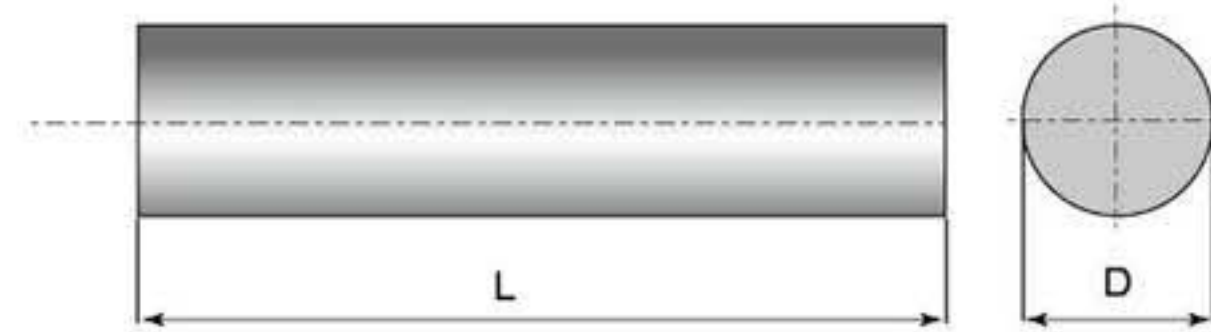

型号	直径公差(mm)	长度公差 (mm)
Type	Tol. of D(mm)	Tol. of L(mm)
CF02001000	h6	+0.5/+0.1
CF02501000	h6	+0.5/+0.1
CF03000500	h6	+0.5/+0.1
CF03500520	h6	+0.5/+0.1
CF04000500	h6	+0.5/+0.1
CF04001000	h6	+0.5/+0.1
CF05000500	h6	+0.5/+0.1
CF05000620	h6	+0.5/+0.1
CF05000860	h6	+0.5/+0.1
CF05001000	h6	+0.5/+0.1
CF05500660	h6	+0.5/+0.1
CF05500930	h6	+0.5/+0.1
CF05501500	h6	+0.5/+0.1
CF06000500	h6	+0.5/+0.1
CF06000570	h6	+0.5/+0.1
CF06000600	h6	+0.5/+0.1
CF06002000	h6	+0.5/+0.1
CF06501550	h6	+0.5/+0.1
CF07000700	h6	+0.5/+0.1
CF07501090	h6	+0.5/+0.1
CF08000600	h6	+0.5/+0.1
CF08001200	h6	+0.5/+0.1
CF08501200	h6	+0.5/+0.1
CF09001270	h6	+0.5/+0.1
CF09001400	h6	+0.5/+0.1
CF09001450	h6	+0.5/+0.1

型号	直径公差(mm)	长度公差 (mm)
Type	Tol. of D(mm)	Tol. of L(mm)
CF09501350	h6	+0.5/+0.1
CF10000600	h6	+0.5/+0.1
CF10001150	h6	+0.5/+0.1
CF10001400	h6	+0.5/+0.1
CF10500950	h6	+0.5/+0.1
CF11000700	h6	+0.5/+0.1
CF11501420	h6	+0.5/+0.1
CF12000600	h6	+0.5/+0.1
CF12001000	h6	+0.5/+0.1
CF12001100	h6	+0.5/+0.1
CF12001600	h6	+0.5/+0.1
CF12501000	h6	+0.5/+0.1
CF12501510	h6	+0.5/+0.1
CF13000750	h6	+0.5/+0.1
CF13501200	h6	+0.5/+0.1
CF14000700	h6	+0.5/+0.1
CF14000750	h6	+0.5/+0.1
CF14001000	h6	+0.5/+0.1
CF14501000	h6	+0.5/+0.1
CF15001300	h6	+0.5/+0.1
CF15501000	h6	+0.5/+0.1
CF16000800	h6	+0.5/+0.1
CF16000930	h6	+0.5/+0.1
CF16001000	h6	+0.5/+0.1
CF16001200	h6	+0.5/+0.1
CF16001400	h6	+0.5/+0.1
CF16501000	h6	+0.5/+0.1
CF17001000	h6	+0.5/+0.1
CF17001450	h6	+0.5/+0.1
CF17501450	h6	+0.5/+0.1
CF18001350	h6	+0.5/+0.1
CF20001000	h6	+0.5/+0.1
CF20001040	h6	+0.5/+0.1
CF20001050	h6	+0.5/+0.1



实心硬质合金精磨棒材

Solid cemented carbide ground rods

企业文化

型号	直径公差(mm)	长度公差 (mm)
Type	Tol. of D(mm)	Tol. of L(mm)
CF20001200	h6	+0.5/+0.1
CF20001500	h6	+0.5/+0.1
CF20501000	h6	+0.5/+0.1
CF21001300	h6	+0.5/+0.1
CF22001500	h6	+0.5/+0.1
CF23001000	h6	+0.5/+0.1
CF23501000	h6	+0.5/+0.1
CF24001000	h6	+0.5/+0.1
CF24501100	h6	+0.5/+0.1
CF25001300	h6	+0.5/+0.1
CF25501500	h6	+0.5/+0.1
CF26001000	h6	+0.5/+0.1
CF26501300	h6	+0.5/+0.1
CF26501500	h6	+0.5/+0.1
CF27001000	h6	+0.5/+0.1
CF27501000	h6	+0.5/+0.1
CF28001000	h6	+0.5/+0.1
CF28501000	h6	+0.5/+0.1
CF29001000	h6	+0.5/+0.1
CF29501000	h6	+0.5/+0.1
CF30001000	h6	+0.5/+0.1
CF30001300	h6	+0.5/+0.1
CF30001500	h6	+0.5/+0.1
CF30501000	h6	+0.5/+0.1
CF31501000	h6	+0.5/+0.1
CF32001000	h6	+0.5/+0.1
CF32001300	h6	+0.5/+0.1
CF32001500	h6	+0.5/+0.1

●可根据顾客的要求特殊订制
We can offer customized rods based on your various special requirements

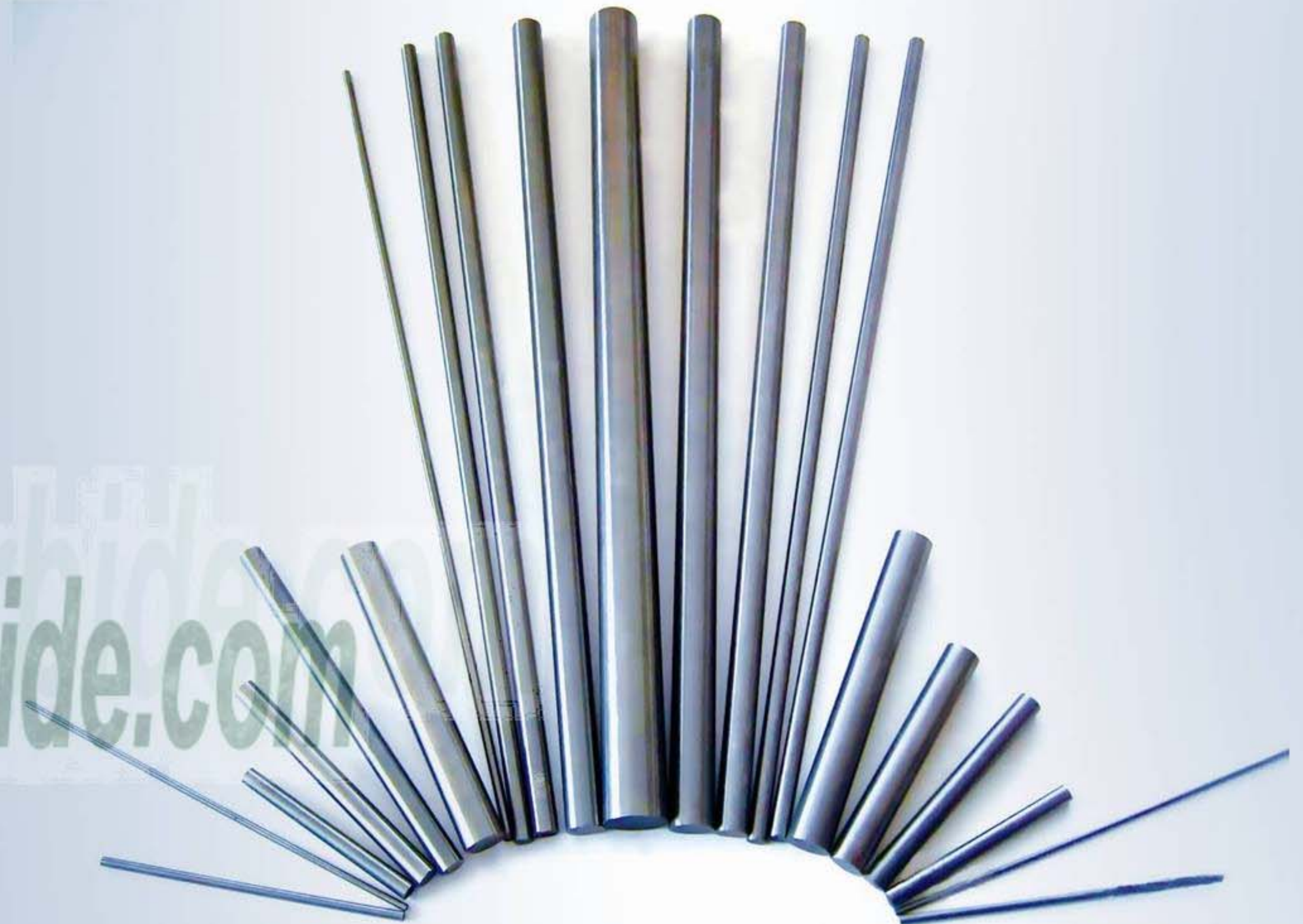

科技创新 铸出好产品
Scientific and technical innovation to supply high-quality products

爱企敬业 结成一家人
Love the enterprise and respecting work to become one family